

# ATTENUATORS

TNC up to 6 GHz, 100 Watts

## SPECIFICATIONS:

Models: XT100W-XX, XT100W-XXF, XT100W-XXM

**RoHS**  
Compliant

<b>Electrical:</b>			
Frequency Range	_____ DC - 6.0 GHz		
Standard Freq. Values	_____ 2.5 & 6 GHz		
Standard dB Values	_____ 3, 6, 10, 20, 30 & 40 dB		
Attenuation Accuracy	DC - 1.5 GHz	1.5 - 2.5 GHz	2.5 - 6 GHz
3 & 6 dB	±0.50 dB	±0.50 dB	±0.75 dB
10 dB	±0.75 dB	±0.75 dB	±2.50 dB
20 & 30 dB	±0.75 dB	±0.75 dB	±1.50 dB
40 dB	±1.50 dB	±1.50 dB	±2.50 dB
VSWR (Max.)	_____ 1.25:1	_____ 1.35:1	_____ 1.45:1
Input Power	_____ 100 Watts Avg.		
	Derated Linearly to 20 Watts @ +125°C		
Reverse Power	_____ 20 Watts Max.		
Peak Power	_____ 1 kW Max.		
	(5uSec Pulse, .05% Duty Cycle)		
Impedance	_____ 50 Ohms		
Operating Temp Range	_____ -55°C to +125°C		
<b>Mechanical:</b>			
TNC Connectors	_____ Passivated Stainless Steel		
	Mates with MILSTD-348		
Conductors	_____ Gold Plated Beryllium Copper		
Housing	_____ Anodized Aluminum		

Custom Mtg. hole Config.  
may be Added to this  
Surface

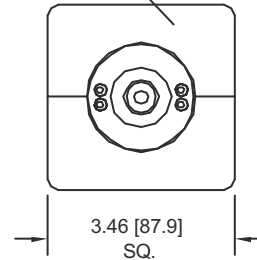

**END VIEW**  
**TYPICAL**

Units must be Mounted in such a way as to  
Allow for Free Air Flow Around fins to Assure  
Performance

Note: Units are Unidirectional, Therefore Input Connector MUST be specified & will be Indicated on Unit

Model Number: **XT100W-XX**  
Male/Female Connectors  
Length: 6.53 ±.05 [165.9 ±1.3]  
Pictured

Model Number: **XT100W-XXF**  
Female/Female Connectors  
Length: 6.62 ±.05 [168.1 ±1.3]

Model Number: **XT100W-XXM**  
Male/Male Connectors  
Length: 6.43 ±.05 [163.3 ±1.3]

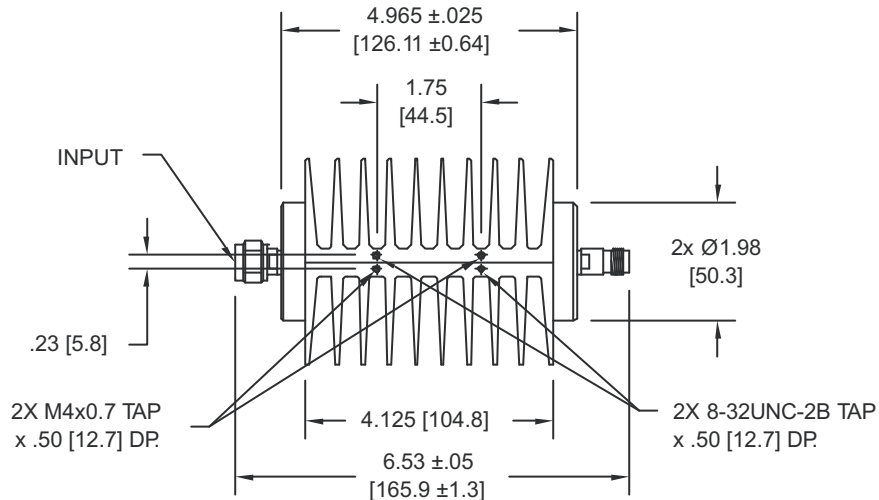

## HOW TO ORDER:

Model Number: **XT100W-XXY**

Freq. Range  
 2 = DC - 2.5 GHz  
 6 = DC - 6 GHz

Connector Configuration  
 = Male/Female (Male Input)  
 F = Fem/Fem  
 M = Male/Male  
 FM = Female/Male (Female Input)

dB Value

## Ordering Examples:

Model Number: **2T100W-01**  
DC - 2.5 GHz, 1 dB; TNC - Male/Fem

Model Number: **2T100W-03F**  
DC - 2.5 GHz, 3 dB; TNC - Fem/Fem

Model Number: **6T100W-20FM**  
DC - 6 GHz, 20 dB; TNC - Female/Male

Note: Dimensions in Brackets are Expressed in Millimeters and are for Reference Only.  
Design, specifications are subject to change without notice. Contact factory for technical specifications before purchasing or use.

XT100W-ATT: REV N



Aeroflex / Inmet, Inc. • 300 Dino Drive, Ann Arbor, MI 48103 • U.S.A.  
888-244-6638 or 734-426-5553 • FAX: 734-426-5557  
www.aeroflex.com/inmet • inmet-sales@eroflex.com

