

# 1,00 mm Spacing

# SERIES 6201

## Through-Hole Right Angle LIF

TYPE 012

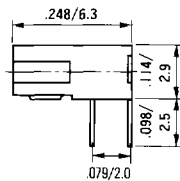
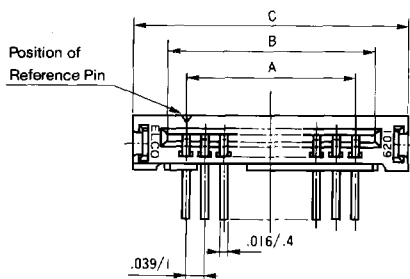
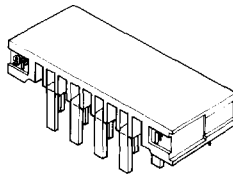
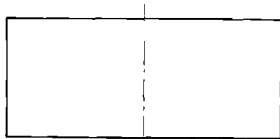

**Specifications:**

- Number of Contacts - 5~20
- Tray Packaged
- Current Rating - 1.0 amp max.
- Voltage - 50 V
- Dielectric Withstanding Voltage - 500 V RMS min.
- Operating Temperature - (-30°C ~ +85°C)
- Contact Material - phosphor bronze (tin-lead plated)
- Insulator Material - PPS, brown (UL 94 V-0)
- Profile Height - 2.9 mm (.114")
- FFC / FPC Thickness - 0,3±0,05 mm (.012±.002")
- PCB Thickness - 0,8 ~ 1,2 mm (.031 ~ .047")

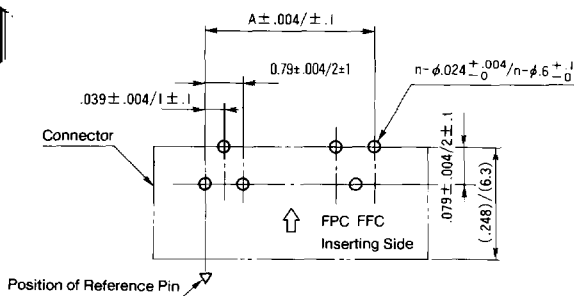

Mounting Hole Pattern (Connector Mounting Side)  
Recommended P.C. Board Thickness (-t.047/12)

| No. of Pos. | A           | B           | C           |
|-------------|-------------|-------------|-------------|
| 5           | .157 / 4.0  | .240 / 6.1  | .374 / 9.5  |
| 6           | .197 / 5.0  | .280 / 7.1  | .413 / 10.5 |
| 7           | .236 / 6.0  | .319 / 8.1  | .453 / 11.5 |
| 8           | .276 / 7.0  | .358 / 9.1  | .492 / 12.5 |
| 9           | .315 / 8.0  | .398 / 10.1 | .531 / 13.5 |
| 10          | .354 / 9.0  | .437 / 11.1 | .571 / 14.5 |
| 11          | .394 / 10.0 | .476 / 12.1 | .610 / 15.5 |
| 12          | .433 / 11.0 | .516 / 13.1 | .650 / 16.5 |
| 13          | .472 / 12.0 | .555 / 14.1 | .689 / 17.5 |
| 14          | .512 / 13.0 | .594 / 15.1 | .728 / 18.5 |
| 15          | .551 / 14.0 | .634 / 16.1 | .768 / 19.5 |
| 16          | .591 / 15.0 | .673 / 17.1 | .807 / 20.5 |
| 17          | .630 / 16.0 | .713 / 18.1 | .846 / 21.5 |
| 18          | .669 / 17.0 | .752 / 19.1 | .886 / 22.5 |
| 19          | .709 / 18.0 | .791 / 20.1 | .925 / 23.5 |
| 20          | .748 / 19.0 | .831 / 21.1 | .965 / 24.5 |

Dimensions inches/mm

## ORDERING CODE

Typical Example

00

6201

057

012

800

## TRAY PACKAGING

## NUMBER OF CONTACTS

5 ~ 20

## VARIATION CODE

012: Plated Thru-Hole Type

Note: Drawings are in inches/millimeters.

# 1,00 mm Spacing

# SERIES 6201

## Surface Mount with Boss Right Angle LIF

TYPE 022

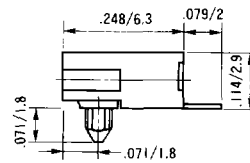
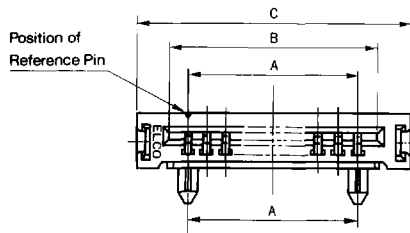
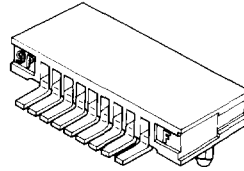
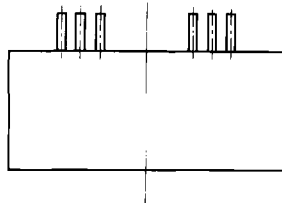

**Specifications:**

- Number of Contacts - 5~20
- Tray Packaged
- Current Rating - 1.0 amp max.
- Voltage - 50 V
- Dielectric Withstanding Voltage - 500 V RMS min.
- Operating Temperature - (-30°C ~ +85°C)
- Contact & Metal Tab Material - phosphor bronze (tin-lead plated)
- Insulator Material - PPS, brown (UL 94 V-O)
- Profile Height - 2.9 mm (.114")
- FFC / FPC Thickness - 0,3±0,05 mm (.012±.002")

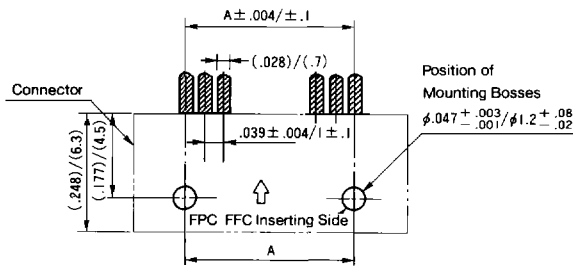

Mounting Hole Pattern (Connector Mounting Side)  
Recommended P.C. Board Thickness (~1.047/1.2)

| No. of Pos. | A           | B           | C           |
|-------------|-------------|-------------|-------------|
| 5           | .157 / 4.0  | .240 / 6.1  | .374 / 9.5  |
| 6           | .197 / 5.0  | .280 / 7.1  | .413 / 10.5 |
| 7           | .236 / 6.0  | .319 / 8.1  | .453 / 11.5 |
| 8           | .276 / 7.0  | .358 / 9.1  | .492 / 12.5 |
| 9           | .315 / 8.0  | .398 / 10.1 | .531 / 13.5 |
| 10          | .354 / 9.0  | .437 / 11.1 | .571 / 14.5 |
| 11          | .394 / 10.0 | .476 / 12.1 | .610 / 15.5 |
| 12          | .433 / 11.0 | .516 / 13.1 | .650 / 16.5 |
| 13          | .472 / 12.0 | .555 / 14.1 | .689 / 17.5 |
| 14          | .512 / 13.0 | .594 / 15.1 | .728 / 18.5 |
| 15          | .551 / 14.0 | .634 / 16.1 | .768 / 19.5 |
| 16          | .591 / 15.0 | .673 / 17.1 | .807 / 20.5 |
| 17          | .630 / 16.0 | .713 / 18.1 | .846 / 21.5 |
| 18          | .669 / 17.0 | .752 / 19.1 | .886 / 22.5 |
| 19          | .709 / 18.0 | .791 / 20.1 | .925 / 23.5 |
| 20          | .748 / 19.0 | .831 / 21.1 | .965 / 24.5 |

Dimensions inches/mm

### ORDERING CODE

Typical Example **00 6201 057 022 800**

TRAY PACKAGING

NUMBER OF CONTACTS

5 ~ 20

VARIATION CODE

022: SMT With Boss

# 1,00 mm Spacing

# SERIES 6201

## Surface Mount with Tabs Right Angle LIF

SMT with Mounting Metal (L-Type) TYPE 032

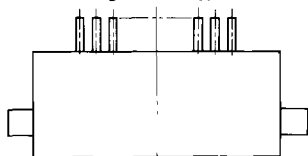

SMT with Mounting Metal (L-Type)

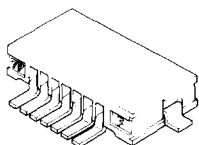

SMT with Mounting Metal (L-Type)/Boss

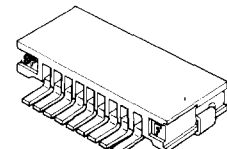
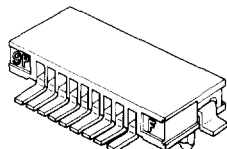

SMT with Mounting Metal (J-Type)

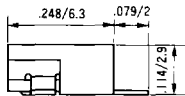
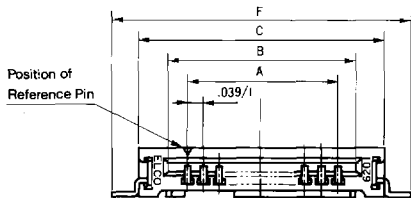

SMT with Mounting Metal (L-Type)/Boss TYPE 052

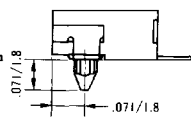
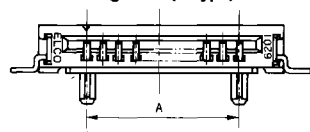

SMT with Mounting Metal (J-Type) TYPE 042

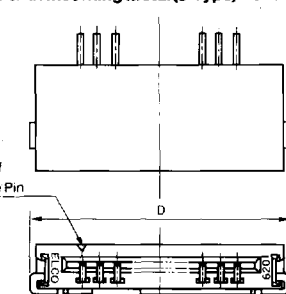

Position of Reference Pin

Position of Mounting Bosses  $\phi .053^{+ .003} - .001 / \phi 1.35^{+ .08} - .02$

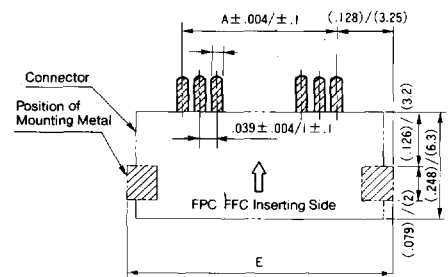
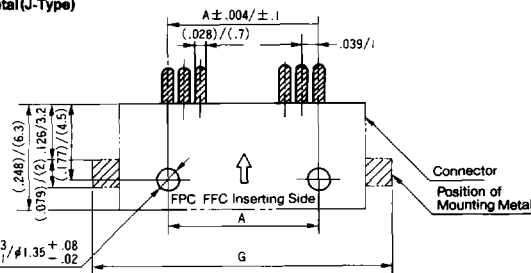

Mounting Hole Pattern/J-Type (Connector Mounting Side)

| No. of Pos. | A           | B           | C           | D           | E            | F            | G            |
|-------------|-------------|-------------|-------------|-------------|--------------|--------------|--------------|
| 5           | .157 / 4.0  | .240 / 6.1  | .374 / 9.5  | .398 / 10.1 | .413 / 10.5  | .500 / 12.7  | .516 / 13.1  |
| 6           | .197 / 5.0  | .280 / 7.1  | .413 / 10.5 | .437 / 11.1 | .453 / 11.5  | .539 / 13.7  | .555 / 14.1  |
| 7           | .236 / 6.0  | .319 / 8.1  | .453 / 11.5 | .476 / 12.1 | .492 / 12.5  | .579 / 14.7  | .594 / 15.1  |
| 8           | .276 / 7.0  | .358 / 9.1  | .492 / 12.5 | .516 / 13.1 | .531 / 13.5  | .618 / 15.7  | .634 / 16.1  |
| 9           | .315 / 8.0  | .398 / 10.1 | .531 / 13.5 | .555 / 14.1 | .571 / 14.5  | .657 / 16.7  | .673 / 17.1  |
| 10          | .354 / 9.0  | .437 / 11.1 | .571 / 14.5 | .594 / 15.1 | .610 / 15.5  | .697 / 17.7  | .713 / 18.1  |
| 11          | .394 / 10.0 | .476 / 12.1 | .610 / 15.5 | .634 / 16.1 | .650 / 16.5  | .736 / 18.7  | .752 / 19.1  |
| 12          | .433 / 11.0 | .516 / 13.1 | .650 / 16.5 | .673 / 17.1 | .689 / 17.5  | .776 / 19.7  | .791 / 20.1  |
| 13          | .472 / 12.0 | .555 / 14.1 | .689 / 17.5 | .713 / 18.1 | .728 / 18.5  | .815 / 20.7  | .831 / 21.1  |
| 14          | .512 / 13.0 | .594 / 15.1 | .728 / 18.5 | .752 / 19.1 | .768 / 19.5  | .854 / 21.7  | .870 / 22.1  |
| 15          | .551 / 14.0 | .634 / 16.1 | .768 / 19.5 | .791 / 20.1 | .807 / 20.5  | .894 / 22.7  | .909 / 23.1  |
| 16          | .591 / 15.0 | .673 / 17.1 | .807 / 20.5 | .831 / 21.1 | .846 / 21.5  | .933 / 23.7  | .949 / 24.1  |
| 17          | .630 / 16.0 | .713 / 18.1 | .846 / 21.5 | .870 / 22.1 | .886 / 22.5  | .972 / 24.7  | .988 / 25.1  |
| 18          | .669 / 17.0 | .752 / 19.1 | .886 / 22.5 | .909 / 23.1 | .925 / 23.5  | 1.012 / 25.7 | 1.028 / 26.1 |
| 19          | .709 / 18.0 | .791 / 20.1 | .925 / 23.5 | .949 / 24.1 | .965 / 24.5  | 1.051 / 26.7 | 1.067 / 27.1 |
| 20          | .748 / 19.0 | .831 / 21.1 | .965 / 24.5 | .988 / 25.1 | 1.004 / 25.5 | 1.091 / 27.7 | 1.106 / 28.1 |

Dimensions inches/mm

## ORDERING CODE

Typical Example

00 6201 057 032 800

## NUMBER OF CONTACTS

5 ~ 20

## VARIATION CODE

032: SMT with Mounting Metal (L-Type) - Tape and Reel- see page 21 for ordering code

042: SMT with Mounting Metal (J-Type) - Tape and Reel- see page 21 for ordering code

052: SMT with Mounting Metal (L-Type) - Tray Packaging

# 1,00 mm Spacing

# SERIES 6201

## Tape & Reel

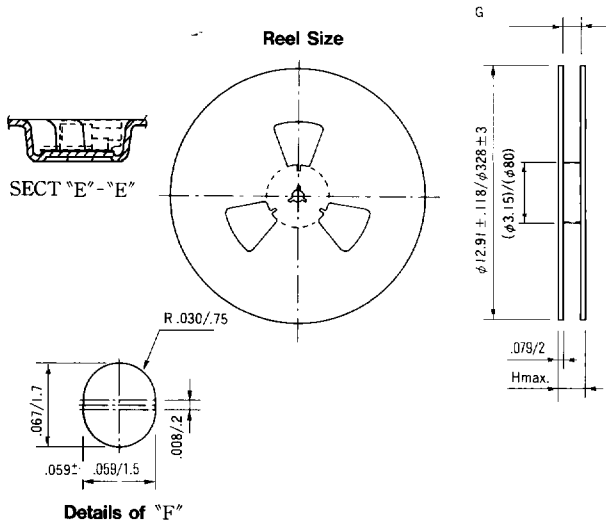
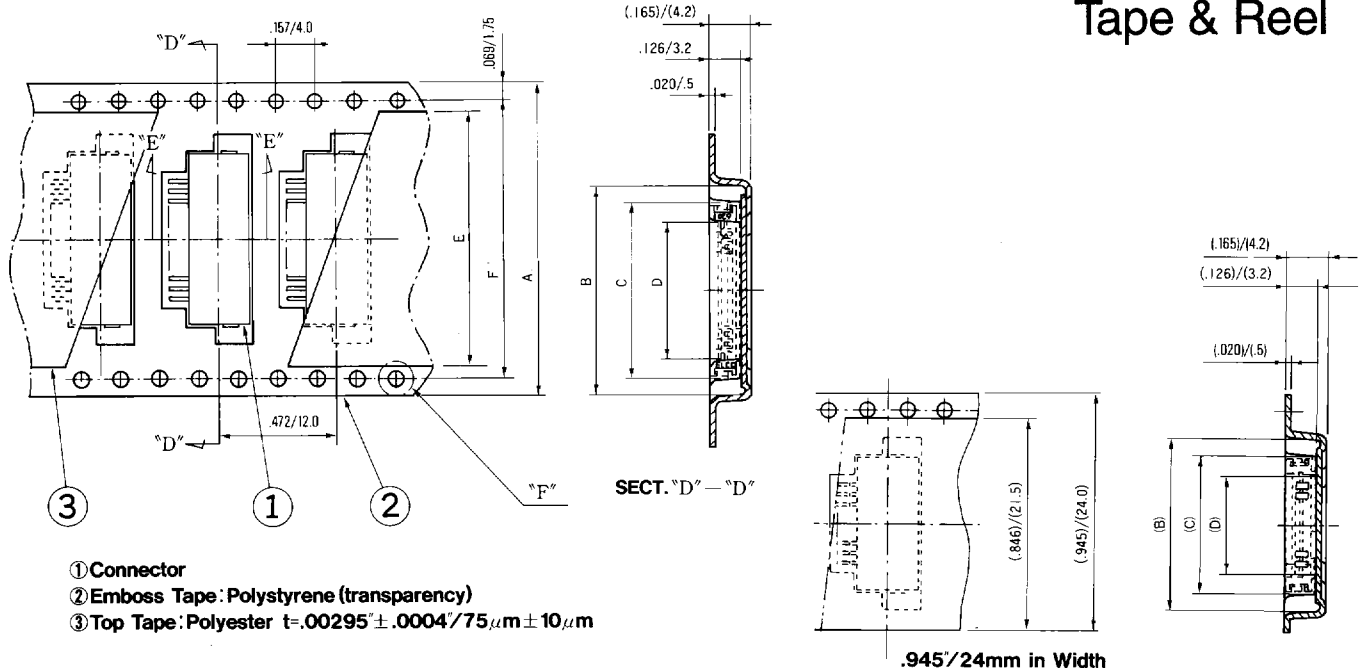

Delivery Quantity 1 Reel: 1000pcs.

| No. of Pos. | A Tape Width | B          | C         | D       | E          | F          | G          | H          |
|-------------|--------------|------------|-----------|---------|------------|------------|------------|------------|
| 05          | .945/24.0    | .531/13.5  | .394/10.0 | .236/ 6 | .846/21.5  |            | .961/24.4  | 1.197/30.4 |
| 06          | .945/24.0    | .571/14.5  | .433/11.0 | .276/ 7 | .846/21.5  |            | .961/24.4  | 1.197/30.4 |
| 07          | .945/24.0    | .610/15.5  | .472/12.0 | .315/ 8 | .846/21.5  |            | .961/24.4  | 1.197/30.4 |
| 08          | .945/24.0    | .650/16.5  | .512/13.0 | .354/ 9 | .846/21.5  |            | .961/24.4  | 1.197/30.4 |
| 09          | .945/24.0    | .689/17.5  | .551/14.0 | .394/10 | .846/21.5  |            | .961/24.4  | 1.197/30.4 |
| 10          | 1.260/32.0   | .728/18.5  | .591/15.0 | .433/11 | 1.024/26.0 | 1.118/28.4 | 1.276/32.4 | 1.512/38.4 |
| 11          | 1.260/32.0   | .768/19.5  | .630/16.0 | .472/12 | 1.024/26.0 | 1.118/28.4 | 1.276/32.4 | 1.512/38.4 |
| 12          | 1.260/32.0   | .807/20.5  | .669/17.0 | .512/13 | 1.024/26.0 | 1.118/28.4 | 1.276/32.4 | 1.512/38.4 |
| 13          | 1.260/32.0   | .846/21.5  | .709/18.0 | .551/14 | 1.024/26.0 | 1.118/28.4 | 1.276/32.4 | 1.512/38.4 |
| 14          | 1.260/32.0   | .886/22.5  | .748/19.0 | .591/15 | 1.024/26.0 | 1.118/28.4 | 1.276/32.4 | 1.512/38.4 |
| 15          | 1.732/44.0   | .925/23.5  | .787/20.0 | .630/16 | 1.457/37.0 | 1.591/40.4 | 1.748/44.4 | 1.984/50.4 |
| 16          | 1.732/44.0   | .965/24.5  | .827/21.0 | .669/17 | 1.457/37.0 | 1.591/40.4 | 1.748/44.4 | 1.984/50.4 |
| 17          | 1.732/44.0   | 1.004/25.5 | .866/22.0 | .707/18 | 1.457/37.0 | 1.591/40.4 | 1.748/44.4 | 1.984/50.4 |
| 18          | 1.732/44.0   | 1.043/26.5 | .906/23.0 | .748/19 | 1.457/37.0 | 1.591/40.4 | 1.748/44.4 | 1.984/50.4 |
| 19          | 1.732/44.0   | 1.083/27.5 | .945/24.0 | .787/20 | 1.457/37.0 | 1.591/40.4 | 1.748/44.4 | 1.984/50.4 |
| 20          | 1.732/44.0   | 1.122/28.5 | .984/25.0 | .827/21 | 1.457/37.0 | 1.591/40.4 | 1.748/44.4 | 1.984/50.4 |

Dimensions inches/mm

## ORDERING CODE

Typical Example **08 6201 057 032 800**

TAPE & REEL PACKAGING

NUMBER OF CONTACTS  
5 ~ 20

VARIATION CODE

032: SMT with Mounting Metal (L-Type)  
042: SMT with Mounting Metal (J-Type)