

D4 (D-SUB COAX INSERTS)



The D4(D-Sub coax inserts) series are miniature coaxial connectors similar to C4(DIN41626 coax inserts) series, with high electrical and mechanical stability and low space requirements, ideal for high density connectors applications, are specially used in the PCB backplane connection of mixtures of high and low frequency for communication equipments.

9 D4

TECHNICAL CHARACTERISTICS

Environmental

Temperature range	-55~ + 125° C
-------------------	---------------

Electrical Characteristics

Characteristic impedance	50Ω
Frequency range	0-2GHz
Working voltage	500V
Contact resistance	Center contact: ≤ 10mΩ, Outer contact: ≤ 5mΩ
Insulation resistance	≥ 1000MΩ
Dielectric withstanding voltage	1500V
VSWR	≤ 1.06, 0~0.1GHz ≤ 1.22, 0~0.5GHz ≤ 1.50, 0.5~2GHz

Material and Plating

Body	Brass, gold/nickel plated
Spring contacts	Beryllium copper, gold plated
Male center contacts	Brass, gold plated
Female center contacts	Beryllium copper, gold plated
Insulators	PTFE
Crimp ferrules	Copper alloy, gold or nickel plated

Mechanical Characteristics

Durability	500 cycles
------------	------------

CNT

XI'AN CONNECTOR TECHNOLOGY LTD.

TEL: 0086-29-8230011/8253388 FAX: 0086-29-8213102 HOT LINE: 8008409889
E-MAIL: sales@xianconnector.com http://www.xianconnector.com

D4 (D-SUB COAX INSERTS)

INTERFACE MATING DIMENSIONS

Letter	JACK (mm)	
	Minimum	Maximum
A	0.99	1.01
B	-	-
C	0.10	0.50
D	9.35	9.50
E	2.22	2.40
F	-	5.25
G	4.76	4.79
H	-	6.00

Letter	PLUG (mm)	
	Minimum	Maximum
A	-	-
B	-	-
C	-	3.85
D	-	4.75
E	-	5.25
F	8.85	9.00
G	0.90	1.10
H	-	6.00
J	4.76	4.79
K	2.22	2.40

PLUG

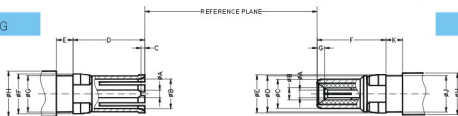

JACK

1. FLEXIBLE CABLE CONNECTORS

Straight Cable Plug, MD3



Part Number	GB Type	Cable Group	Remarks
DF1112001	D4-J2	2/50S	A=10.5, B=2.5, C=1.0
DF1112002	D4-J2.5	2.6/50S	A=12.5, B=2.8, C=1.6
DF1112003	D4-J2.5D	2.6/50D	A=13.5, B=3.4, C=1.6
DF1112004	D4-J3	3/50S	A=12.5, B=3.1, C=1.6
DF1112005	D4-J4	4/50S	A=15.0, B=4.2, C=2.3
DF1112006	D4-J5	5/50S	A=17.0, B=5.2, C=3.1
DF1112012	D4-J23	5/50D	A=17.0, B=5.2, C=3.1

Straight Cable Plug, MD1



DF1112007	D4-J2.5A	2.6/50S	A=9.50, B=2.8, C=1.6
DF1112008	D4-J2.5DA	2.6/50D	A=9.50, B=3.4, C=1.6
DF1112009	D4-J3A	3/50S	A=9.00, B=3.1, C=1.6
DF1112010	D4-J4A	4/50S	A=12.0, B=4.2, C=2.3
DF1112011	D4-J5A	5/50S	A=15.0, B=5.2, C=3.1

CNT

XI'AN CONNECTOR TECHNOLOGY LTD.

TEL: 0086-29-8230011/8253388 FAX: 0086-29-8213102 HOT LINE: 8008409889
E-MAIL: sales@xianconnector.com http://www.xianconnector.com

D4 (D-SUB COAX INSERTS)

1. CABLE CONNECTORS

Straight Cable Plug, MD1



Part Number	GB Type	Cable Group	Remarks
DF1111001	D4-JB2	085	A=24.8, B=2.2
DF1111002	D4-JB3	.141	A=23.0, B=3.6

Right Angle Cable Plug, MD4



DF2112001	D4-JW2	2/50S	A=16.8, B=2.5, C=1.0
DF2112002	D4-JW2.5	2.6/50S	A=17.3, B=2.8, C=1.6
DF2112003	D4-JW2.5D	2.6/50D	A=17.3, B=3.4, C=1.6
DF2112004	D4-JW3	3/50S	A=16.8, B=3.1, C=1.6
DF2112005	D4-JW4	4/50S	A=18, B=3.4, C=2.3
DF2112006	D4-JW5	5/50S	A=19, B=4.4, C=3.1

Straight Cable Jack, MD3



DF1212001	D4-K2	2/50S	A=10.5, B=2.5, C=1.0
DF1212002	D4-K2.5	2.6/50S	A=12.5, B=2.8, C=1.6
DF1212003	D4-K2.5D	2.6/50D	A=13.5, B=3.4, C=1.6
DF1212004	D4-K3	3/50S	A=12.5, B=3.1, C=1.6
DF1212005	D4-K4	4/50S	A=15.0, B=4.2, C=2.3
DF1212006	D4-K5	5/50S	A=17.0, B=5.2, C=3.1

Straight Cable Jack, MD1



DF1212007	D4-K2.5A	2.6/50S	A=9.5, B=2.8, C=1.6
DF1212008	D4-K2.5DA	2.6/50D	A=9.5, B=3.4, C=1.6
DF1212009	D4-K3A	3/50S	A=9.0, B=3.1, C=1.6
DF1212010	D4-K4A	4/50S	A=12, B=4.2, C=2.3
DF1212011	D4-K5A	5/50S	A=15, B=5.2, C=3.1

Straight Cable Jack, MD1



DF1211003	D4-KB2	085	A=23.1, B=2.2
DF1211002	D4-KB3	.141	A=21.3, B=3.6

Straight Cable Jack, Solder

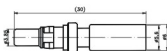

DF1211004	D4-K223H	5/50D	
-----------	----------	-------	--