

# C-FILTER D-SUB STANDARD

Solder cup – Precision machined contacts – For wire size AWG 20



RoHS compliant – CSA listed, File No.: LR 115000-1 – UL listed, File No.: E202784

## DESCRIPTION

- Suitable for wire size **AWG 20**
- Mounting styles:
  - with through-hole, Ø .118"/3 mm
  - with 4-40 UNC or M3 threaded insert
- Quality class 3 (also available in quality class 1)
- Shell: Steel tin plated (brass tin plated on request)

## SOCKET CONNECTOR

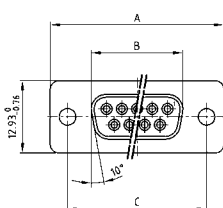

No. of pos.	A -0.76	B -0.25	C
09	31.19	16.46	25.00 <sup>+0.12</sup> / <sub>-0.13</sub>
15	39.52	24.79	33.30 <sup>+0.15</sup> / <sub>-0.10</sub>
25	53.42	38.50	47.04 <sup>+0.13</sup> / <sub>-0.10</sub>
37	69.70	54.96	63.50 <sup>+0.13</sup> / <sub>-0.10</sub>

Mounting style: Through-hole

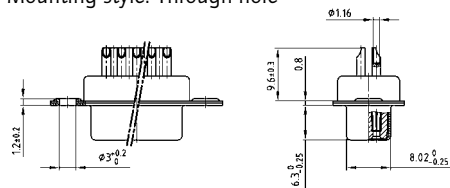

Mounting style: Threaded insert

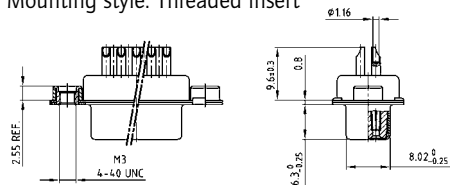

## PLUG CONNECTOR

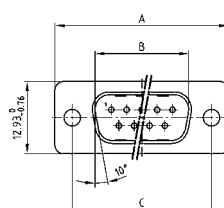

No. of pos.	A -0.76	B +0.25	C	D -0.3
09	31.19	16.79	25.00 <sup>+0.12</sup> / <sub>-0.13</sub>	6.12
15	39.52	25.12	33.30 <sup>+0.15</sup> / <sub>-0.10</sub>	6.12
25	53.42	38.84	47.04 <sup>+0.13</sup> / <sub>-0.10</sub>	5.99
37	69.70	55.30	63.50 <sup>+0.13</sup> / <sub>-0.10</sub>	5.99

Mounting style: Through-hole

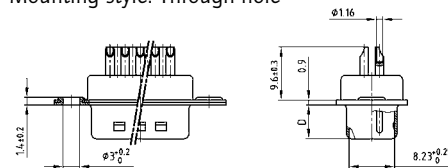

Mounting style: Threaded insert

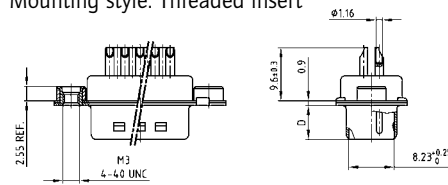

## ORDER DATA

### Capacitance 180 pF

#### SOCKET CONNECTOR

No. of pos.	Mounting style	Part Number
09	Through-hole	242 A 26740 X
15	Through-hole	242 A 26750 X
25	Through-hole	242 A 26760 X
37	Through-hole	242 A 26770 X
09	4-40 UNC Threaded insert	242 A 26900 X
15	4-40 UNC Threaded insert	242 A 26910 X
25	4-40 UNC Threaded insert	242 A 26920 X
37	4-40 UNC Threaded insert	242 A 26930 X
09	M3 Threaded insert	242 A 27060 X
15	M3 Threaded insert	242 A 27070 X
25	M3 Threaded insert	242 A 27080 X
37	M3 Threaded insert	242 A 27090 X

#### PLUG CONNECTOR

No. of pos.	Mounting style	Part Number
09	Through-hole	241 A 26840 X
15	Through-hole	241 A 26850 X
25	Through-hole	241 A 26860 X
37	Through-hole	241 A 26870 X
09	4-40 UNC Threaded insert	241 A 27000 X
15	4-40 UNC Threaded insert	241 A 27010 X
25	4-40 UNC Threaded insert	241 A 27020 X
37	4-40 UNC Threaded insert	241 A 27030 X
09	M3 Threaded insert	241 A 27160 X
15	M3 Threaded insert	241 A 27170 X
25	M3 Threaded insert	241 A 27180 X
37	M3 Threaded insert	241 A 27190 X

# C-FILTER D-SUB STANDARD

Solder cup – Precision machined contacts – For wire size AWG 20

ORDER DATA

## Capacitance 370 pF

SOCKET CONNECTOR			PLUG CONNECTOR		
No. of pos.	Mounting style	Part Number	No. of pos.	Mounting style	Part Number
09	Through-hole	242 A 26780 X	09	Through-hole	241 A 26880 X
15	Through-hole	242 A 26790 X	15	Through-hole	241 A 26890 X
25	Through-hole	242 A 26800 X	25	Through-hole	241 A 26900 X
37	Through-hole	242 A 26810 X	37	Through-hole	241 A 26910 X
09	4-40 UNC Threaded insert	242 A 26940 X	09	4-40 UNC Threaded insert	241 A 27040 X
15	4-40 UNC Threaded insert	242 A 26950 X	15	4-40 UNC Threaded insert	241 A 27050 X
25	4-40 UNC Threaded insert	242 A 26960 X	25	4-40 UNC Threaded insert	241 A 27060 X
37	4-40 UNC Threaded insert	242 A 26970 X	37	4-40 UNC Threaded insert	241 A 27070 X
09	M3 Threaded insert	242 A 27100 X	09	M3 Threaded insert	241 A 27200 X
15	M3 Threaded insert	242 A 27110 X	15	M3 Threaded insert	241 A 27210 X
25	M3 Threaded insert	242 A 27120 X	25	M3 Threaded insert	241 A 27220 X
37	M3 Threaded insert	242 A 27130 X	37	M3 Threaded insert	241 A 27230 X

## Capacitance 830 pF

SOCKET CONNECTOR			PLUG CONNECTOR		
No. of pos.	Mounting style	Part Number	No. of pos.	Mounting style	Part Number
09	Through-hole	242 A 26820 X	09	Through-hole	241 A 26920 X
15	Through-hole	242 A 26830 X	15	Through-hole	241 A 26930 X
25	Through-hole	242 A 26840 X	25	Through-hole	241 A 26940 X
37	Through-hole	242 A 26850 X	37	Through-hole	241 A 26950 X
09	4-40 UNC Threaded insert	242 A 26980 X	09	4-40 UNC Threaded insert	241 A 27080 X
15	4-40 UNC Threaded insert	242 A 26990 X	15	4-40 UNC Threaded insert	241 A 27090 X
25	4-40 UNC Threaded insert	242 A 27000 X	25	4-40 UNC Threaded insert	241 A 27100 X
37	4-40 UNC Threaded insert	242 A 27010 X	37	4-40 UNC Threaded insert	241 A 27110 X
09	M3 Threaded insert	242 A 27140 X	09	M3 Threaded insert	241 A 27240 X
15	M3 Threaded insert	242 A 27150 X	15	M3 Threaded insert	241 A 27250 X
25	M3 Threaded insert	242 A 27160 X	25	M3 Threaded insert	241 A 27260 X
37	M3 Threaded insert	242 A 27170 X	37	M3 Threaded insert	241 A 27270 X

## Capacitance 1300 pF

SOCKET CONNECTOR			PLUG CONNECTOR		
No. of pos.	Mounting style	Part Number	No. of pos.	Mounting style	Part Number
09	Through-hole	242 A 26860 X	09	Through-hole	241 A 26960 X
15	Through-hole	242 A 26870 X	15	Through-hole	241 A 26970 X
25	Through-hole	242 A 26880 X	25	Through-hole	241 A 26980 X
37	Through-hole	242 A 26890 X	37	Through-hole	241 A 26990 X
09	4-40 UNC Threaded insert	242 A 27020 X	09	4-40 UNC Threaded insert	241 A 27120 X
15	4-40 UNC Threaded insert	242 A 27030 X	15	4-40 UNC Threaded insert	241 A 27130 X
25	4-40 UNC Threaded insert	242 A 27040 X	25	4-40 UNC Threaded insert	241 A 27140 X
37	4-40 UNC Threaded insert	242 A 27050 X	37	4-40 UNC Threaded insert	241 A 27150 X
09	M3 Threaded insert	242 A 27180 X	09	M3 Threaded insert	241 A 27280 X
15	M3 Threaded insert	242 A 27190 X	15	M3 Threaded insert	241 A 27290 X
25	M3 Threaded insert	242 A 27200 X	25	M3 Threaded insert	241 A 27300 X
37	M3 Threaded insert	242 A 27210 X	37	M3 Threaded insert	241 A 27310 X