

# Power Splitter/Combiner

## ZB4PD1-23DC+

4 Way-0° 50Ω 1200 to 1600 MHz



### Maximum Ratings

Operating Temperature	-55°C to 100°C
Storage Temperature	-55°C to 100°C
Power Input (as a splitter)	10W max.
Internal Dissipation	0.375W max.
V <sub>DC</sub>	50V
I <sub>DC</sub>	1A

### Coaxial Connections

SUM PORT (RF + DC)	S
PORT 1 (RF + DC)	1
PORT 2 (RF ONLY)	2
PORT 3 (RF ONLY)	3
PORT 4 (RF ONLY)	4

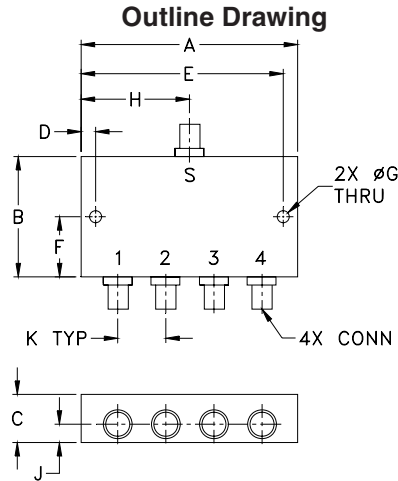

### Outline Dimensions (inch/mm)

A	B	C	D	E	F	
3.50	2.13	.88	.150	3.350	1.06	
88.90	54.10	22.35	3.81	85.09	26.92	
G	H	J	K			wt
.125	1.75	.44	.89			grams
3.18	44.45	11.18	22.61			260

### Features

- wideband, 1200 to 1600 MHz
- good isolation, 25 dB typ.
- excellent output VSWR, 1.1:1 typ.
- up to 10W power input as a splitter
- DC Pass from sum port to port 1

### Applications

- GPS - L1, L2

SMA version shown  
CASE STYLE: UU188

Connectors	Model	Price	Qty.
SMA	ZB4PD1-23DC-S+		Contact Sales Dept.
N-TYPE	ZB4PD1-23DC-N+		

+ RoHS compliant in accordance with EU Directive (2002/95/EC)

The +Suffix has been added in order to identify RoHS Compliance. See our web site for RoHS Compliance methodologies and qualifications.

### Splitter Electrical Specifications

FREQ. RANGE (MHz)	ISOLATION (dB)		INSERTION LOSS (dB) ABOVE 6.0 dB		PHASE UNBALANCE (Degrees)	AMPLITUDE UNBALANCE (dB)	VSWR (:1)			
	Typ.	Min.	Typ.	Max.			S Typ.	S Max.	OUT Typ.	OUT Max.
1200-1600	25	20	0.6	1.0	—	0.4	1.20	1.43	1.15	1.43

### Typical Performance Data

Freq. (MHz)	Insertion Loss (dB)				Amp. Unbal. (dB)	Isolation (dB)			VSWR S	VSWR 1	VSWR 2	VSWR 3	VSWR 4
	S-1	S-2	S-3	S-4		1-2	2-3	3-4					
1200.00	6.14	6.27	6.26	6.23	0.13	25.92	34.55	25.81	1.15	1.03	1.05	1.06	1.07
1250.00	6.22	6.31	6.28	6.22	0.10	25.96	32.33	25.80	1.18	1.02	1.04	1.05	1.06
1300.00	6.17	6.28	6.28	6.21	0.12	26.40	30.61	26.24	1.21	1.01	1.04	1.04	1.05
1350.00	6.24	6.33	6.31	6.27	0.10	27.35	29.35	27.19	1.23	1.01	1.04	1.04	1.04
1400.00	6.22	6.32	6.30	6.19	0.13	28.85	28.39	28.66	1.25	1.01	1.04	1.04	1.05
1450.00	6.16	6.26	6.32	6.26	0.16	30.93	27.73	30.72	1.25	1.02	1.03	1.04	1.05
1500.00	6.25	6.36	6.32	6.22	0.14	33.68	27.21	33.45	1.24	1.03	1.03	1.03	1.06
1550.00	6.20	6.31	6.32	6.25	0.12	36.98	27.03	36.60	1.24	1.04	1.02	1.03	1.06
1600.00	6.23	6.34	6.36	6.24	0.14	38.87	26.99	38.71	1.22	1.05	1.02	1.03	1.06

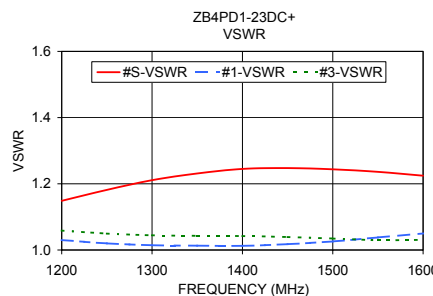
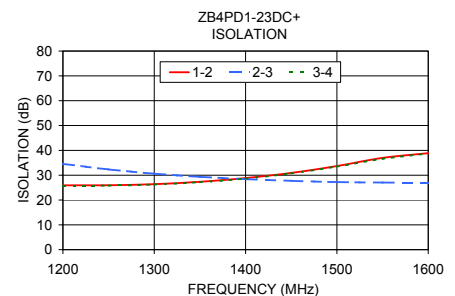
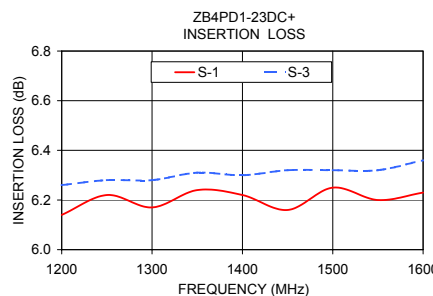

### electrical schematic



For detailed performance specs & shopping online see web site

P.O. Box 350166, Brooklyn, New York 11235-0003 (718) 934-4500 Fax (718) 332-4661 [www.minicircuits.com](http://www.minicircuits.com) Provides ACTUAL Data Instantly at [minicircuits.com](http://minicircuits.com)

Notes: 1. Performance and quality attributes and conditions not expressly stated in this specification sheet are intended to be excluded and do not form a part of this specification sheet. 2. Electrical specifications and performance data contained herein are based on Mini-Circuits' applicable established test performance criteria and measurement instructions. 3. The parts covered by this specification sheet are subject to Mini-Circuits standard limited warranty and terms and conditions (collectively, "Standard Terms"); Purchasers of this part are entitled to the rights and benefits contained therein. For a full statement of the Standard Terms and the exclusive rights and remedies thereunder, please visit Mini-Circuits' website at [www.minicircuits.com/MCLStore/terms.jsp](http://www.minicircuits.com/MCLStore/terms.jsp).

REV. A  
M121747  
ZB4PD1-23DC+  
ED-12323/1  
HY/QL  
090821