

## Inductive proximity switch

## IFRM 08 (short)

## sample drawing

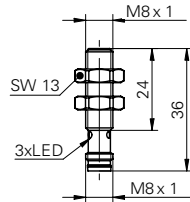

standard cable length 200 mm (L)

## general data

mounting type	flush
nominal sensing distance $S_n$	2 mm
hysteresis	3 ... 20 % of $S_r$

## electrical data

switching frequency	< 5 kHz
voltage supply range +Vs	10 ... 30 VDC
current consumption max. (no load)	12 mA
voltage drop $V_d$	< 2 VDC
output current	< 200 mA
short circuit protection	yes
reverse polarity protection	yes

## mechanical data

type	cylindrical threaded
material (sensing face)	PBT
housing material	stainless steel
dimension	8 mm

## cable, 2 m

housing length	30 mm
----------------	-------

## flylead connector M8

housing length	30 mm
----------------	-------

## connector M8

housing length	36 mm
----------------	-------

## ambient conditions

operating temperature	-25 ... +75 °C
protection class	IP 67

## sample picture



## Inductive proximity switch

## IFRM 08 (short)

order reference	connection types	output circuit	output indicator
IFRM 08N1701/KS35L	flylead connector M8	NPN make function (NO)	LED red
IFRM 08N1701/L	cable, 2 m	NPN make function (NO)	LED red
IFRM 08N17A3/S35L	connector M8	NPN make function (NO)	3 port LED red
IFRM 08N3701/KS35L	flylead connector M8	NPN break function (NC)	LED red
IFRM 08N3701/L	cable, 2 m	NPN break function (NC)	LED red
IFRM 08N37A3/S35L	connector M8	NPN break function (NC)	3 port LED red
IFRM 08P1701/KS35L	flylead connector M8	PNP make function (NO)	LED red
IFRM 08P1701/L	cable, 2 m	PNP make function (NO)	LED red
IFRM 08P17A3/S35L	connector M8	PNP make function (NO)	3 port LED red
IFRM 08P3701/KS35L	flylead connector M8	PNP break function (NC)	LED red
IFRM 08P3701/L	cable, 2 m	PNP break function (NC)	LED red
IFRM 08P37A3/S35L	connector M8	PNP break function (NC)	3 port LED red