

Commercial Version MIL-C-5015 Compatible

A

D/MS



D/MS series connectors are intermateable and intermountable with MIL-C-5015 connectors.

The D/MS series offers:

- Hard dielectric interior (diallyl phthalate)
- Zinc plated die cast aluminum shells with Trivalent chromate finish (no cadmium is used)
- A selection of over 73 insert arrangements spanning 12 shell sizes and 5 contact sizes
- Pre-solder cup terminations
- A choice of class A (one-piece) and class B (two-piece) backshell configuration

D/MS series connector are designed for use in a wide range of general industrial applications.

FEATURE

- Improved Dielectric Withstanding Voltage (DWV):

An insulation barrier ridge between each contact position effectively increases the creepage distance across the surfaces of the insert, thus increasing DWV.

- Stable Insert Dielectric Material:

Molded Diallyl Phthalate inserts maintain their dielectric, mechanical, and dimensional properties over a wide range of temperature, humidity, and aging conditions.

- Wide Range Configurations:

A choice of over 73 insert arrangements, plus a variety of shell styles and hardware, results in a range of configurations to meet most application needs.

- Shells Keyed to Prevent Mis-Mating:

Receptacle key and plug keyway mate before contacts engage to ensure proper contact mating. Alternate rotated insert positions further ensure against mis-mating of similar connectors.

- Superior Strength of Coupling Ring:

Coupling rings are machined from bar stock to provide superior coupling thread strength as compared to die cast products.

- Quick and Easy Termination:

Contacts are pre-loaded in the connector. Pre-solder cups are permanently oriented in one direction to simplify termination.

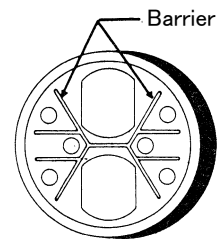

DDK



OTHER

APPLICATION

The DMS series is designed and manufactured for reliable performance in a broad range of electric/electronic equipment applications. These include machine tools, communications, instrumentation and high current systems.

MATERIAL/FINISH

Contact	Copper alloy/Silver or optional Gold plating
Insulator	Diallyl phthalate resin/Blue
Shell	Aluminum alloy/Zinc plating, Olive drab chromate finish (Black)
Coupling Ring	Aluminum alloy/Zinc plating, Olive drab chromate finish (Black)
Retaining Ring	Phosphor bronze/Nickel plating
Cap	Aluminum alloy/Zinc plating, Olive drab chromate finish (Black)
Chain	Stainless steel

Wire Size

Contact Size	Wire Size
#16	AWG#16—#22
#12	AWG#12—#14
#8	AWG#8—#10
#4	AWG#4—#6
#0	AWG#0—#2

Contact Current Rating

Contact Size	Test current (Amperes)
#16	13
#12	23
#8	46
#4	80
#0	150

Service Rating

Service Rating	Operating Voltage (V)	
	DC	AC
INST	250	200
A	700	500
D	1250	900
E	1750	1250
B	2450	1750
C	4200	3000

Maximum total current connector is the same as the allowable current for wire bundles as specified in MIL-W-5088.

D/MS3102A18-10PY(62)

A
D/MS

Connector Shape

D/MS3100A
Wall Mounting Receptacle
(Solid Shell)



(12S~36 Size)

D/MS3101A
Cable Connecting Receptacle
(Solid Shell)



(12S~36 Size)

D/MS3102A
Box Mounting Receptacle



(10SL~36 Size)

D/MS3106A
Straight Plug (Solid Shell)



(10SL~36 Size)

D/MS3106B
Straight Plug (Split Shell)



(12S~36 Size)

D/MS3108B
Angle Plug (Split Shell)



(12S~36 Size)

Deviation
(62) : Gold Plating Contacts
Omit : Silver Plating Contacts

Insert Key Positions
W, X, Y, Z Alternate Position

Please see details at page 7.

Contact Type
P : Pin Contact
S : Socket Contact

Shell Size
10SL, 12S, 14S, 16S, 16,
18, 20, 22, 24, 28, 32, 36

Insert Arrangements
Please refer to page
4 through page 6
about details.

Insert Arrangements (Front View of Pin Insert)

1 Contact	2 Contacts				
<p>20-2 1-#0 Serv. D</p>	<p>10SL-4 2-#16 Serv. A</p>	<p>12S-3 2-#16 Serv. A</p>	<p>14S-9 2-#16 Serv. A</p>	<p>20-23 2-#8 Serv. A</p>	<p>32-5 2-#0 Serv. D</p>

3 Contacts							
<p>10SL-3 3-#16 Serv. A</p>	<p>14S-1 3-#16 Serv. A</p>	<p>14S-7 3-#16 Serv. A</p>	<p>16S-5 3-#16 Serv. A</p>	<p>16-10 3-#12 Serv. A</p>	<p>18-5 2-#12, 1-#16 Serv. D</p>	<p>18-21 3-#12 Serv. A</p>	
<p>18-22 3-#16 Serv. D</p>	<p>22-2 3-#8 Serv. D</p>	<p>28-6 3-#4 Serv. D</p>	<p>36-4 3-#0 Serv. D (A) A (BC)</p>				

4 Contacts					
<p>14S-2 4-#16 Serv. INST</p>	<p>18-4 4-#16 Serv. D</p>	<p>18-10 4-#12 Serv. A</p>	<p>20-4 4-#12 Serv. D</p>	<p>22-10 4-#16 Serv. E</p>	<p>22-22 4-#8 Serv. A</p>
<p>24-22 4-#8 Serv. D</p>	<p>32-17 4-#4 Serv. D</p>	<p>36-5 4-#0 Serv. A</p>			

Contact Sizes

#16 #12 #8 #4 #0

Insert Arrangements (Front View of Pin Insert)

5 Contacts		6 Contacts			
 14S-5 5-#16 Serv. INST	 16S-8 5-#16 Serv. A	 18-11 5-#12	 18-20 5-#16		
 32-1 2-#0, 3-#12 Serv. E(A) D(Others)		 32-2 3-#4, 2-#16 Serv. E			
		 14S-6 6-#16 Serv. INST	 18-12 6-#16 Serv. A	 20-17 5-#12, 1-#16 Serv. A	
		 20-22 3-#8, 3-#16 Serv. A	 36-3 3-#0, 3-#12 Serv. D		
7 Contacts			8 Contacts	9 Contacts	
 16S-1 7-#16 Serv. A	 20-15 7-#12 Serv. A	 22-28 7-#12 Serv. A	 18-8 1-#12, 7-#16 Serv. A	 20-16 2-#12, 7-#16 Serv. A	
 24-2 7-#12 Serv. D	 24-10 7-#8 Serv. A	 28-10 2-#4, 2-#8, 3-#12 Serv. D(G) A(Others)	 20-7 8-#16 Serv. D (ABHG) A (CDEF)	 20-18 3-#12, 6-#16 Serv. A	
			 22-23 8-#12 Serv. D (H) A (Others)	 24-11 3-#8, 6-#12 Serv. A	
10 Contacts	11 Contacts	14 Contacts			
 18-1 10-#16 Serv. A (BCFG) INST (Others)	 24-20 2-#12, 9-#16 Serv. D	 20-27 14-#16 Serv. A	 22-19 14-#16 Serv. A	 28-20 10-#12, 4-#16 Serv. A	
 18-19 10-#16 Serv. A	 32-9 2-#4, 12-#16 Serv. D			<p>Contact Sizes</p>	

Insert Arrangements (Front View of Pin Insert)

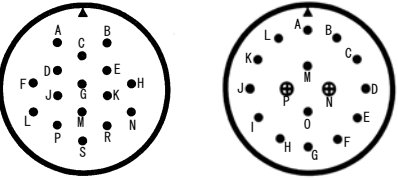
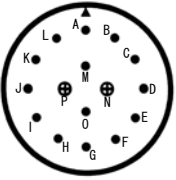
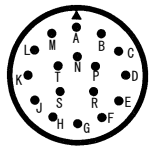
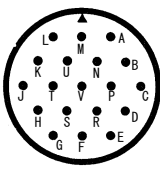
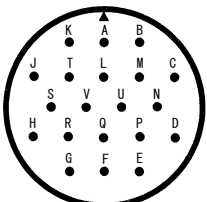
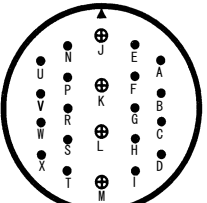
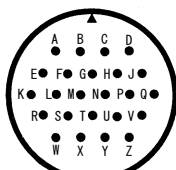
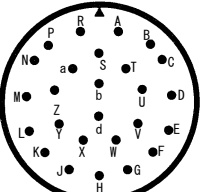
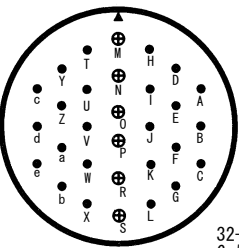
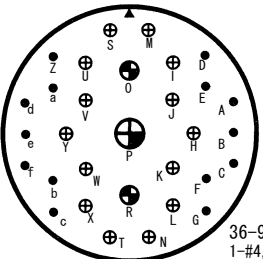
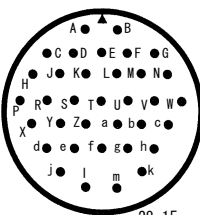
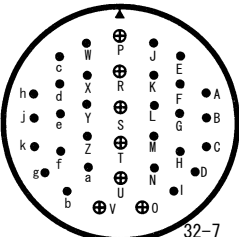
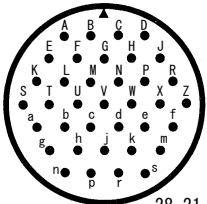
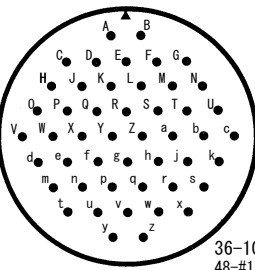
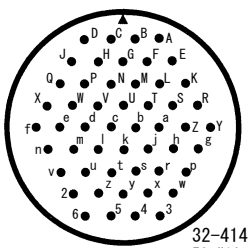
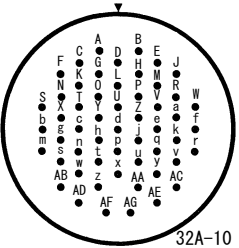
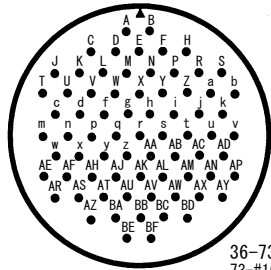
16 Contacts	17 Contacts	19 Contacts	20 Contacts
 <p>24-5 16-#16 Serv. A</p>  <p>24-7 2-#12, 14-#16 Serv. A</p>	 <p>20-29 17-#16 Serv. A</p>	 <p>22-14 19-#16 Serv. A</p>	 <p>28-16 20-#16 Serv. A</p>
22 Contacts	24 Contacts	26 Contacts	30 Contacts
 <p>28-11 4-#12, 18-#16 Serv. A</p>	 <p>24-28 24-#16 Serv. A</p>	 <p>28-12 26-#16 Serv. A</p>	 <p>32-8 6-#12, 24-#16 Serv. A</p>
31 Contacts	35 Contacts	37 Contacts	
 <p>36-9 1-#4, 2-#8 14-#12, 14-#16 Serv. A</p>	 <p>28-15 35-#16 Serv. A</p>	 <p>32-7 7-#12, 28-#16 Serv. INST (ABhj) A (others)</p>	
 <p>28-21 37-#12 Serv. A</p>			
48 Contacts	52 Contacts	54 Contacts	73 Contacts
 <p>36-10 48-#16 Serv. A</p>	 <p>32-414 52-#16 Serv. A</p>	 <p>32A-10 54-#16 Serv. A</p>	 <p>36-73 73-#16 Serv. A</p>

Contact Sizes



Alternate Insert Key Positions

A
D/MS

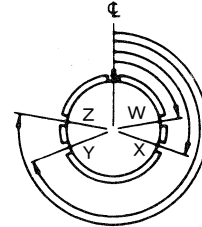
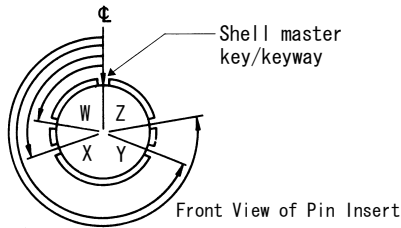

No. of Contacts	Insert No.	W	X	Y	Z
1	20-2	—	—	—	—
2	10SL-4	—	—	—	—
	12S-3	70°	145°	215°	290°
	14S-9	70°	145°	215°	290°
	20-23	35°	110°	250°	325°
	32-5	35°	110°	250°	325°
3	10SL-3	—	—	—	—
	14S-1	—	—	—	—
	14S-7	90°	180°	270°	—
	16S-5	70°	145°	215°	290°
	16-10	90°	180°	270°	—
	18-5	80°	110°	250°	280°
	18-21	—	—	—	—
	18-22	70°	145°	215°	290°
	22-2	70°	145°	215°	290°
	28-6	70°	145°	215°	290°
4	36-4	70°	145°	215°	290°
	14S-2	—	120°	240°	—
	18-4	35°	110°	250°	325°
	18-10	—	120°	240°	—
	20-4	45°	110°	250°	—
	22-10	35°	110°	250°	325°
	22-22	—	110°	250°	—
	24-22	45°	110°	250°	—
	32-17	45°	110°	250°	—
36-5	—	120°	240°	—	
5	14S-5	—	110°	—	—
	16S-8	—	170°	265°	—
	18-11	—	170°	265°	—
	18-20	90°	180°	270°	—
	32-1	80°	110°	250°	280°
	32-2	70°	145°	215°	290°
6	14S-6	—	—	—	—
	18-12	80°	—	—	280°
	20-17	90°	180°	270°	—
	20-22	80°	—	250°	280°
	36-3	70°	145°	215°	290°

No. of Contacts	Insert No.	W	X	Y	Z
7	16S-1	80°	—	—	280°
	20-15	80°	—	—	280°
	22-28	80°	—	—	280°
	24-2	80°	—	—	280°
	24-10	80°	—	—	280°
	28-10	80°	110°	250°	280°
8	18-8	70°	—	—	290°
	20-7	80°	110°	250°	280°
	22-23	35°	—	—	—
9	20-16	80°	110°	250°	280°
	20-18	35°	110°	250°	325°
	24-11	35°	110°	250°	325°
10	18-1	70°	145°	215°	290°
	18-19	—	120°	240°	—
11	24-20	80°	110°	250°	280°
14	20-27	35°	110°	250°	325°
	22-19	80°	110°	250°	280°
	28-20	80°	110°	250°	280°
16	32-9	80°	110°	250°	280°
	24-5	80°	110°	250°	280°
17	24-7	80°	110°	250°	280°
	20-29	80°	—	—	280°
19	22-14	80°	110°	250°	280°
20	28-16	80°	110°	250°	280°
22	28-11	80°	110°	250°	280°
24	24-28	80°	110°	250°	280°
26	28-12	90°	180°	270°	—
30	32-8	80°	125°	235°	280°
31	36-9	80°	125°	235°	280°
35	28-15	80°	110°	250°	280°
	32-7	80°	125°	235°	280°
37	28-21	80°	110°	250°	280°
48	36-10	80°	125°	235°	280°
52	32-414	80°	110°	250°	280°
54	32A-10	—	—	—	—
73	36-73	80°	110°	250°	280°

Insert Specifications

Insert No.	No. of Contacts	Services Rating	Contacts Size					Receptacle			Plug		
			#0	#4	#8	#12	#16	D/MS 3100A	D/MS 3101A	D/MS 3102A	D/MS 3106A	D/MS 3106B	D/MS 3108B
10SL-3	3	A					3			P ※	S ※		
10SL-4	2	A					2			P ※	S ※		
12S-3	2	A					2	●	●	●	●	●	●
14S-1	3	A					3	●	●	●	●	●	●
14S-2	4	INST					4	●	●	●	●	●	●
14S-5	5	INST					5	●	●	●	●	●	●
14S-6	6	INST					6	●	●	●	●	●	●
14S-7	3	A					3	●	●	●	●	●	●
14S-9	2	A					2	●	●	●	●	●	●
16S-1	7	A					7	●	●	●	●	●	●
16S-5	3	A					3	●	●	●	●	●	●
16S-8	5	A					5	●	●	●	●	●	●
16-10	3	A				3		●	●	●	●	●	●
18-1	10	A					4	●	●	●	●	●	●
		INST				6							
18-4	4	D					4	●	●	●	●	●	●
18-5	3	D				2	1	●	●	●	●	●	●
18-8	8	A				1	7	●	●	●	●	●	●
18-10	4	A				4		●	●	●	●	●	●
18-11	5	A				5		●	●	●	●	●	●
18-12	6	A					6	●	●	●	●	●	●
18-19	10	A					10	●	●	●	●	●	●
18-20	5	A					5	●	●	●	●	●	●
18-21	3	A				3		●	●	●	●	●	●
18-22	3	D					3	●	●	●	●	●	●
20-2	1	D	1					●	●	●	●	●	●
20-4	4	D				4		●	●	●	●	●	●
20-7	8	D					4	●	●	●	●	●	●
		A				4							
20-15	7	A				7		●	●	●	●	●	●
20-16	9	A				2	7	●	●	●	●	●	●
20-17	6	A				5	1	●	●	●	●	●	●
20-18	9	A				3	6	●	●	●	●	●	●
20-22	6	A			3		3	●	●	●	●	●	●
20-23	2	A			2			●	●	●	●	●	●
20-27	14	A					14	●	●	●	●	●	●
20-29	17	A					17	●	●	●	●	●	●
22-2	3	D			3			●	●	●	●	●	●
22-10	4	E					4	●	●	●	●	●	●
22-14	19	A					19	●	●	●	●	●	●
22-19	14	A					14	●	●	●	●	●	●
22-22	4	A			4			●	●	●	●	●	●
22-23	8	D				1		●	●	●	●	●	●
		A				7							
22-28	7	A				7		●	●	●	●	●	●
24-2	7	D				7		●	●	●	●	●	●
24-5	16	A					16	●	●	●	●	●	●
24-7	16	A				2	14	●	●	●	●	●	●
24-10	7	A			7			●	●	●	●	●	●
24-11	9	A			3	6		●	●	●	●	●	●
24-20	11	D				2	9	●	●	●	●	●	●
24-22	4	D			4			●	●	●	●	●	●
24-28	24	INST					24	●	●	●	●	●	●
28-6	3	D		3				●	●	●	●	●	●
28-10	7	D				1		●	●	●	●	●	●
		A		2	2	2							
28-11	22	A				4	18	●	●	●	●	●	●
28-12	26	A					26	●	●	●	●	●	●
28-15	35	A					35	●	●	●	●	●	●
28-16	20	A					20	●	●	●	●	●	●
28-20	14	A				10	4	●	●	●	●	●	●
28-21	37	A					37	●	●	●	●	●	●

Note : Insert number 10SL-3 and 10SL-4 are available with the following part numbers only:

D/MS3102A10SL-3P, DMS3102A10SL-4P

D/MS3106A10SL-3S, DMS3106A10SL-4S

D/MS Series

A
D/MS

Insert No.	No. of Contacts	Services Rating	Contact Size					Receptacle			Plug		
			#0	#4	#8	#12	#16	D/MS 3100A	D/MS 3101A	D/MS 3102A	D/MS 3106A	D/MS 3106B	D/MS 3108B
32-1	5	E				1		●	●	●	●	●	●
		D	2			2		●	●	●	●	●	●
32-2	5	E		3			2	●	●	●	●	●	●
32-5	2	D	2					●	●	●	●	●	●
32-7	35	A				7	24	●	●	●	●	●	●
		INST					4	●	●	●	●	●	●
32-8	30	A				6	24	●	●	●	●	●	●
32-9	14	D		2			12	●	●	●	●	●	●
32A-10	54	A					54	●	●	●	●	●	●
32-17	4	D		4				●	●	●	●	●	●
32-414	52	A					52	●	●	●	●	●	●
36-3	6	D	3			3		●	●	●	●	●	●
36-4	3	D	1					●	●	●	●	●	●
		A	2					●	●	●	●	●	●
36-5	4	A	4					●	●	●	●	●	●
36-9	31	A		1	2	14	14	●	●	●	●	●	●
36-10	48	A					48	●	●	●	●	●	●
36-73	73	A					73	●	●	●	●	●	●

Assembly

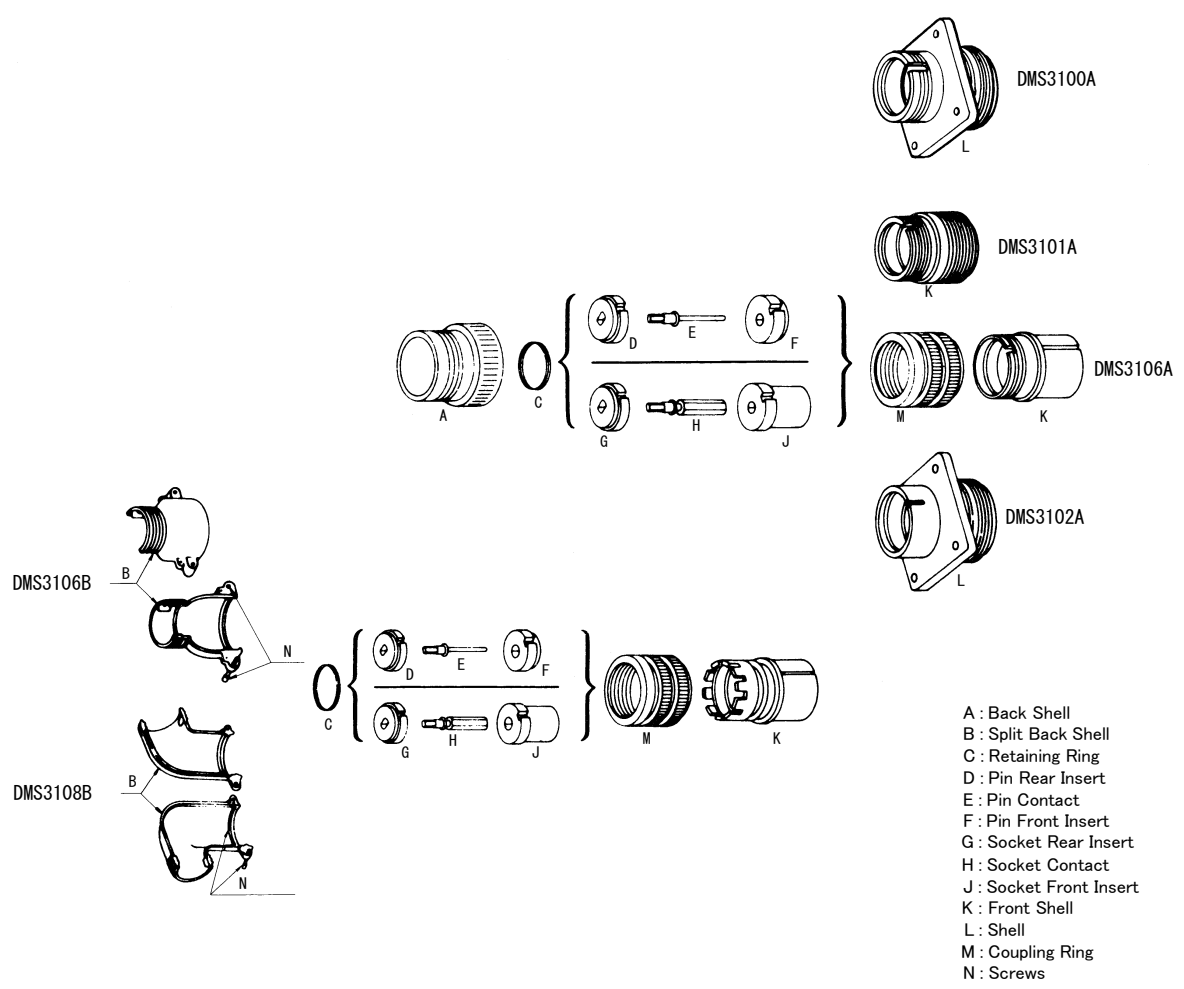

Wall Mounting Receptacle, Solid Shell

D/MS3100A

Shell Size	Coapling Threads A	B	K	L	M	ϕN	R	S	ϕT	Rear Threads V	W
12S	3/4-20UNEF	9.53	2.1	37.9	14.28	19.89	20.62	27.8	3.05	5/8-24UNEF	9.53
14S	7/8-20UNEF	9.53	2.1	37.5	14.28	22.29	23.01	30.2	3.05	3/4-20UNEF	9.53
16S	1-20UNEF	9.53	2.1	37.5	14.28	25.45	24.61	32.5	3.05	7/8-20UNEF	9.53
16	1-20UNEF	15.88	3.2	47.9	19.05	25.45	24.61	32.5	3.05	7/8-20UNEF	9.53
18	1 1/8-18UNEF	15.88	3.2	51.1	19.05	28.64	26.97	34.9	3.05	1-20UNEF	9.53
20	1 1/4-18UNEF	15.88	3.2	54.0	19.05	31.81	29.36	38.1	3.05	1 3/16-18UNEF	9.53
22	1 3/8-18UNEF	15.88	3.2	54.0	19.05	34.99	31.75	41.3	3.05	1 3/16-18UNEF	9.53
24	1 1/2-18UNEF	15.88	3.2	57.2	20.63	38.15	34.93	44.4	3.74	1 7/16-18UNEF	9.53
28	1 3/4-18UNS	15.88	3.2	57.2	20.63	44.51	39.67	50.8	3.74	1 7/16-18UNEF	9.53
32	2-18UNS	15.88	3.7	60.4	22.23	51.24	44.45	57.2	4.40	1 3/4-18UNS	11.13
36	2 1/4-16UN	15.88	3.7	60.4	22.23	57.21	49.23	63.5	4.40	2-18UNS	12.70

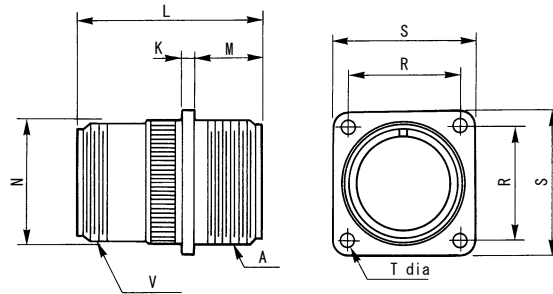

Panel mounting dimension

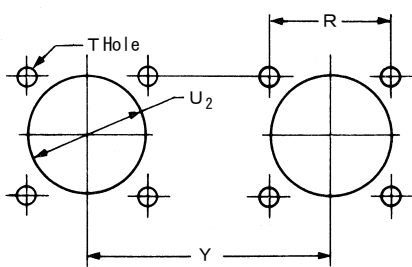

Rear mounting

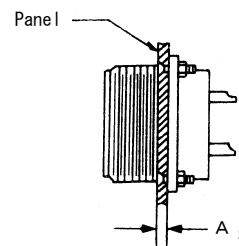

Shell Size	Y	R	T	U2	A2	Fixed screw	F Gasket
10SL	47	18.26	3.05	16.6	3.0	M3	P-100841-10SL
12S	50	20.62	3.05	19.8	3.0	M3	P-100841-12
14S	53	23.01	3.05	23.0	3.0	M3	P-100841-14
16S, 16	56	24.61	3.05	26.1	3.0	M3	P-100841-16
18	59	26.97	3.05	29.3	3.0	M3	P-100841-18
20	62	29.36	3.05	32.5	3.0	M3	P-100841-20
22	70	31.75	3.05	35.7	3.0	M3	P-100841-22
24	73	34.92	3.75	38.8	3.0	M3.5	P-100841-24
28	80	39.67	3.75	45.2	3.0	M3.5	P-100841-28
32	86	44.45	4.40	51.5	3.0	M4	P-100841-32
36	92	49.23	4.40	57.9	3.0	M4	P-100841-36

■ Cable Connecting Receptacle (Solid Shell type)

D/MS3101A

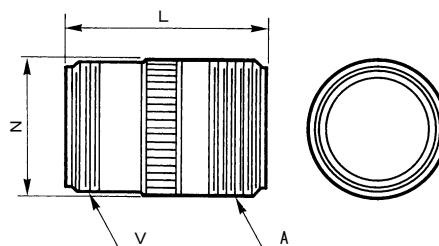

Shell Size	Coupling Threads A	B	L	ϕN	Rear Threads V	W
12S	3/4-20UNEF	9.53	37.9	19.90	5/8-24UNEF	9.53
14S	7/8-20UNEF	9.53	37.5	22.29	3/4-20UNEF	9.53
16S	1-20UNEF	9.53	37.5	25.47	7/8-20UNEF	9.53
16	1-20UNEF	15.88	47.9	25.47	7/8-20UNEF	9.53
18	1 1/8-18UNEF	15.88	51.1	28.64	1-20UNEF	9.53
20	1 1/4-18UNEF	15.88	54.0	31.81	1 3/16-18UNEF	9.53
22	1 3/8-18UNEF	15.88	54.0	34.99	1 3/16-18UNEF	9.53
24	1 1/2-18UNEF	15.88	57.2	38.17	1 7/16-18UNEF	9.53
28	1 3/4-18UNS	15.88	57.2	44.52	1 7/16-18UNEF	9.53
32	2-18UNS	15.88	60.4	51.25	1 3/4-18UNS	11.13
36	2 1/4-16UN	15.88	60.4	57.22	2-18UNS	12.70

Box Mounting Receptacle

D/MS3102A

Shell Size	Coapling Threads A	B	K	L	M	ϕN	R	S	ϕT	W
10SL	5/8-24UNEF	9.53	2.1	30.25	14.28	15.9	18.26	25.4	3.05	21.9
12S	3/4-20UNEF	9.53	2.1	30.25	14.28	17.5	20.62	27.8	3.05	24.0
14S	7/8-20UNEF	9.53	2.1	30.25	14.28	19.1	23.01	30.2	3.05	24.0
16S	1-20UNEF	9.53	2.1	30.25	14.28	22.2	24.61	32.5	3.05	24.0
16	1-20UNEF	15.88	3.2	44.45	19.05	22.2	24.61	32.5	3.05	34.4
18	1 1/8-18UNEF	15.88	3.2	49.22	19.05	25.4	26.97	34.9	3.05	34.4
20	1 1/4-18UNEF	15.88	3.2	49.22	19.05	28.6	29.36	38.1	3.05	34.4
22	1 3/8-18UNEF	15.88	3.2	49.22	19.05	31.8	31.75	41.3	3.05	34.4
24	1 1/2-18UNEF	15.88	3.2	49.22	20.63	34.9	34.92	44.4	3.74	34.4
28	1 3/4-18UNS	15.88	3.2	49.22	20.63	41.3	39.67	50.8	3.74	34.4
32	2-18UNS	15.88	3.7	49.22	22.23	48.4	44.45	57.2	4.40	36.7
36	2 1/4-16UN	15.88	3.7	49.22	22.23	54.0	49.23	63.5	4.40	36.7

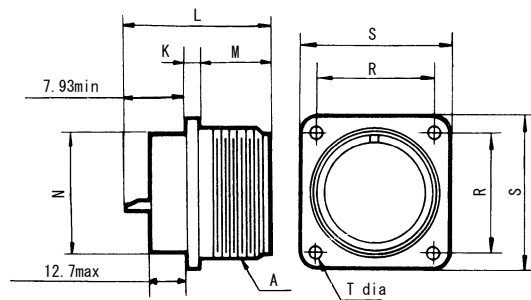
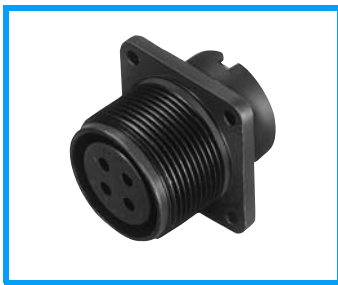

Panel mounting dimension

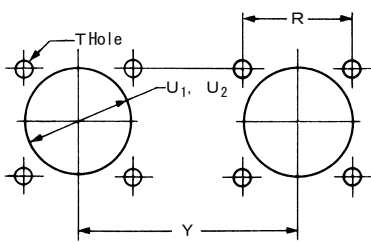

Front mounting Rear mounting

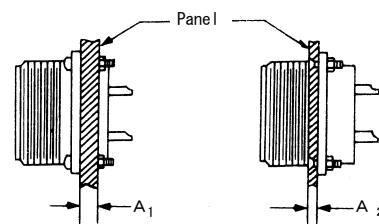

Shell Size	Y	R	T	U1	U2	A1	A2	Fixed screw	R Gasket	F Gasket
10SL	47	18.26	3.05	16.8	16.6	10	3.0	M3	P-100842-10SL	P-100841-10SL
12S	50	20.62	3.05	18.4	19.8	10	3.0	M3	P-100842-12	P-100841-12
14S	53	23.01	3.05	20.0	23.0	10	3.0	M3	P-100842-14	P-100841-14
16S, 16	56	24.61	3.05	23.1	26.1	10	3.0	M3	P-100842-16	P-100841-16
18	59	26.97	3.05	26.4	29.3	10	3.0	M3	P-100842-18	P-100841-18
20	62	29.36	3.05	29.5	32.5	10	3.0	M3	P-100842-20	P-100841-20
22	70	31.75	3.05	32.7	35.7	10	3.0	M3	P-100842-22	P-100841-22
24	73	34.92	3.75	35.9	38.8	10	3.0	M3.5	P-100842-24	P-100841-24
28	80	39.67	3.75	42.2	45.2	10	3.0	M3.5	P-100842-28	P-100841-28
32	86	44.45	4.40	49.3	51.5	10	3.0	M4	P-100842-32	P-100841-32
36	92	49.23	4.40	54.9	57.9	10	3.0	M4	P-100842-36	P-100841-36

■ Straight Plug (Solid Shell type)

D/MS3106A

Shell Size	Coapling Threads A	J	L	ϕQ	ϕN	Rear Threads V	W
10SL	5/8-24UNEF	13.49	34.9	22.22	19.12	5/8-24UNEF	9.53
12S	3/4-20UNEF	13.49	36.5	25.40	19.89	5/8-24UNEF	9.53
14S	7/8-20UNEF	13.49	36.5	28.57	22.29	3/4-20UNEF	9.53
16S	1-20UNEF	13.49	36.9	31.75	25.45	7/8-20UNEF	9.53
16	1-20UNEF	18.26	48.0	31.75	25.45	7/8-20UNEF	9.53
18	1 1/8-18UNEF	18.26	50.8	34.13	28.64	1-20UNEF	9.53
20	1 1/4-18UNEF	18.26	54.0	37.28	31.81	1 3/16-18UNEF	9.53
22	1 3/8-18UNEF	18.26	54.0	40.48	34.99	1 3/16-18UNEF	9.53
24	1 1/2-18UNEF	18.26	57.2	43.63	38.15	1 7/16-18UNEF	9.53
28	1 3/4-18UNS	18.26	57.2	50.00	44.51	1 7/16-18UNEF	9.53
32	2-18UNS	18.26	60.3	56.33	51.24	1 3/4-18UNS	11.13
36	2 1/4-16UN	18.26	60.3	62.68	57.21	2-18UNS	12.70

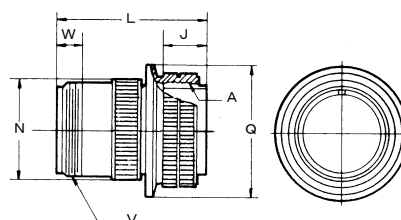

■ Straight Plug (Split Shell type)

D/MS3106B

Shell Size	Coapling Threads A	J	L	ϕ Q	Rear Threads V	W	Y
12S	3/4-20UNEF	13.49	42.88	25.40	5/8-24UNEF	9.53	27
14S	7/8-20UNEF	13.49	42.88	28.57	3/4-20UNEF	8.00	30
16S	1-20UNEF	13.49	42.88	31.75	7/8-20UNEF	8.50	32
16	1-20UNEF	18.26	53.37	31.75	7/8-20UNEF	8.50	32
18	1 1/8-18UNEF	18.26	52.37	34.13	1-20UNEF	9.53	42
20	1 1/4-18UNEF	18.26	55.57	37.28	1 3/16-18UNEF	9.53	47
22	1 3/8-18UNEF	18.26	55.57	40.48	1 3/16-18UNEF	9.53	50
24	1 1/2-18UNEF	18.26	58.72	43.63	1 7/16-18UNEF	9.53	53
28	1 3/4-18UNS	18.26	58.72	50.00	1 7/16-18UNEF	9.53	59
32	2-18UNS	18.26	61.92	56.33	1 3/4-18UNS	11.13	66
36	2 1/4-16UN	18.26	61.92	62.68	2-18UNS	12.70	73

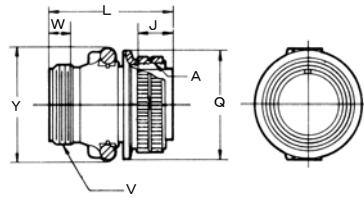

■ Angle Plug (Split Shell type)

D/MS3108B

Shell Size	Caopling Threads A	J	L	ϕ Q	R	U	Rear Threads V	W
12S	3/4-20UNEF	13.49	50.80	25.40	10.5	25.4	5/8-24UNEF	9.53
14S	7/8-20UNEF	13.49	53.97	28.57	14.9	27.0	3/4-20UNEF	9.53
16S	1-20UNEF	13.49	60.32	31.75	18.5	28.6	7/8-20UNEF	9.53
16	1-20UNEF	18.26	65.07	31.75	18.5	28.6	7/8-20UNEF	9.53
18	1 1/8-18UNEF	18.26	68.27	34.13	20.5	30.2	1-20UNEF	9.53
20	1 1/4-18UNEF	18.26	76.98	37.28	22.5	33.3	1 3/16-18UNEF	9.53
22	1 3/8-18UNEF	18.26	76.98	40.48	24.1	33.3	1 3/16-18UNEF	9.53
24	1 1/2-18UNEF	18.26	86.51	43.63	25.6	36.5	1 7/16-18UNEF	9.53
28	1 3/4-18UNS	18.26	86.51	50.00	28.8	36.5	1 7/16-18UNEF	9.53
32	2-18UNS	18.26	95.25	56.33	32.8	44.4	1 3/4-18UNS	11.13
36	2 1/4-16UN	18.26	100.00	62.68	36.0	49.2	2-18UNS	12.70

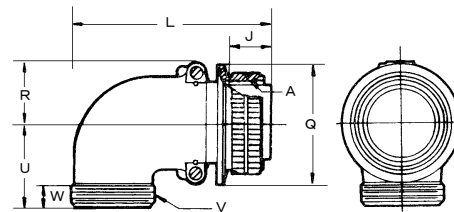

■ Cable Clamp

D/MS3057-□□A

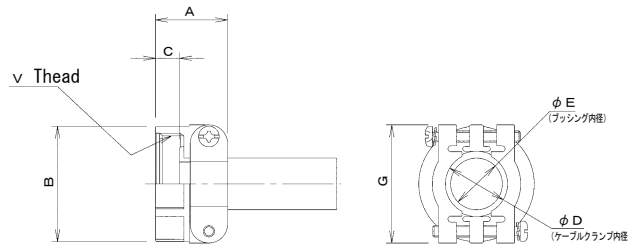

P/N	Shell Size	A	B	C	D	E	G	Thread V	Bushing P/N
D/MS3057-4A	10SL,12S	20.6	20.6	10.3	7.9	5.6	22.2	5/8-24UNEF	AN3420-4
D/MS3057-6A	14S	22.2	24.6	10.3	11.2	7.9	27.0	3/4-20UNEF	AN3420-6
D/MS3057-8A	16S,16	23.8	27.8	10.3	14.3	11.1	29.4	7/8-20UNEF	AN3420-8
D/MS3057-10A	18	23.8	30.1	10.3	15.9	14.3	31.7	1-20UNEF	AN3420-10
D/MS3057-12A	20,22	23.8	35.0	10.3	19.0	15.9	37.3	1 3/16-18UNEF	AN3420-12
D/MS3057-16A	24,28	26.2	42.1	10.3	23.8	19.1	42.9	1 7/16-18UNEF	AN3420-16
D/MS3057-20A	32	27.8	51.6	11.9	31.7	23.8	51.6	1 3/4-18UNS	AN3420-20
D/MS3057-24A	36	29.4	56.4	13.5	34.9	31.8	58.0	2-18UNS	AN3420-24

■ Rubber Bushing

AN3420-□□

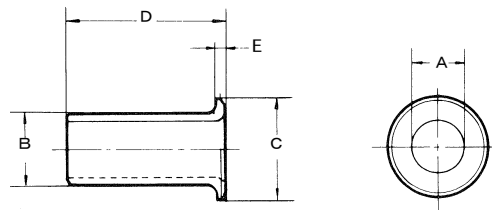

P/N	φ A	φ B	φ C	D	E
AN3420-4	5.6	7.7	14.5	69.8	2.3
AN3420-6	7.9	10.8	17.5	66.7	2.3
AN3420-8	11.1	14.0	20.8	63.5	2.3
AN3420-10	14.3	15.6	23.7	60.3	2.3
AN3420-12	15.9	18.8	28.2	57.2	2.3
AN3420-16	19.1	23.5	35.0	54.0	2.9
AN3420-20	23.8	31.5	42.8	50.8	2.9
AN3420-24	31.8	34.7	48.8	47.6	2.9

■ Cap with chain (Plug type)

Material/Finish.....Aluminum alloy/Zinc plating, Trivalent Chromate finish (Black)

D/MS25042-□□D

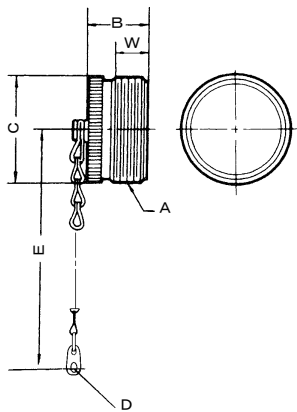

P/N	Shell Size	A	B	φC	φD	E	W
D/MS25042-10D	10SL	5/8-24UNEF	15.9	15.9	3.9	101	8.4
D/MS25042-12D	12S	3/4-20UNEF	20.7	19.1	3.9	114	12.4
D/MS25042-14D	14S	7/8-20UNEF	20.7	22.2	3.9	114	12.4
D/MS25042-16D	16S, 16	1-20UNEF	20.7	25.4	3.9	114	12.4
D/MS25042-18D	18	1 1/8-18UNEF	20.7	28.6	3.9	114	12.4
D/MS25042-20D	20	1 1/4-18UNEF	20.7	31.8	4.7	127	12.4
D/MS25042-22D	22	1 3/8-18UNEF	20.7	34.9	4.7	127	12.4
D/MS25042-24D	24	1 1/2-18UNEF	20.7	38.1	4.7	139	12.4
D/MS25042-28D	28	1 3/4-18UNS	20.7	44.5	4.7	190	12.4
D/MS25042-32D	32	2-18UNS	20.7	50.8	5.5	190	12.4
D/MS25042-36D	36	2 1/4-16UN	20.7	57.2	5.5	190	12.4

■ Cap with chain (Receptacle type)

Material/Finish.....Aluminum alloy/Zinc plating, Trivalent Chromate finish (Black)

D/MS25043-□□D

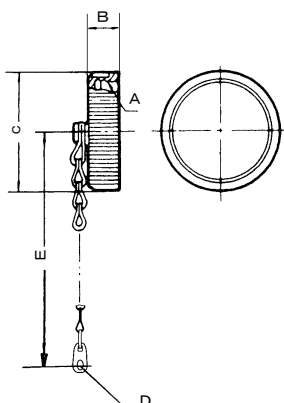

P/N	Shell Size	A	B	φC	φD	E
D/MS25043-10D	10SL	5/8-24UNEF	11.1	19.1	3.5	101
D/MS25043-12D	12S	3/4-20UNEF	11.1	22.2	3.5	114
D/MS25043-14D	14S	7/8-20UNEF	11.1	25.4	3.5	114
D/MS25043-16D	16S, 16	1-20UNEF	11.1	29.4	3.5	114
D/MS25043-18D	18	1 1/8-18UNEF	11.1	31.8	3.5	114
D/MS25043-20D	20	1 1/4-18UNEF	11.1	34.9	3.5	127
D/MS25043-22D	22	1 3/8-18UNEF	11.1	38.1	3.5	127
D/MS25043-24D	24	1 1/2-18UNEF	11.1	42.9	4.3	139
D/MS25043-28D	28	1 3/4-18UNS	12.7	48.8	4.3	190
D/MS25043-32D	32	2-18UNS	12.7	55.6	4.7	190
D/MS25043-36D	36	2 1/4-16UN	12.7	61.9	4.7	190

Dust Cap

Material.....Polyethylene

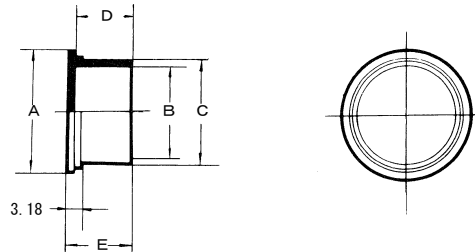
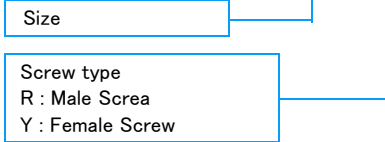
97121-4 □ □ □

97121-4 □ □ Y

P/N	φA	φB	φC	D	E
97121-410Y	19.0	13.5	15.1	15.9	16.8
97121-412Y	21.8	16.6	18.2	15.9	16.8
97121-414Y	26.2	19.9	21.5	15.9	16.8
97121-416Y	28.6	22.7	24.5	15.9	16.8
97121-418Y	31.7	26.0	27.6	15.9	16.8
97121-420Y	35.7	29.2	30.9	15.9	16.8
97121-422Y	38.1	32.3	34.0	15.9	16.8
97121-424Y	41.7	35.3	37.1	15.9	16.8
97121-428Y	47.6	41.9	43.6	15.9	16.8
97121-432Y	54.0	48.0	50.0	15.9	16.8
97121-436Y	59.4	54.4	56.1	15.9	16.8

97121-4 □ □ R

P/N	φA	φB	φC	D	E
97121-410R	21.3	15.4	16.9	12.7	13.6
97121-412R	24.6	18.3	19.7	12.7	13.6
97121-414R	28.6	21.6	23.0	12.7	13.6
97121-416R	31.0	24.7	26.3	12.7	13.6
97121-418R	33.8	27.8	29.3	14.3	15.2
97121-420R	37.2	31.3	33.0	14.3	15.2
97121-422R	40.4	34.0	35.8	14.3	15.2
97121-424R	43.2	37.2	38.9	14.3	15.2
97121-428R	49.5	43.6	45.5	14.3	15.2
97121-432R	56.4	49.9	51.8	14.3	15.2
97121-436R	61.8	56.3	58.2	15.2	16.1

Applicable table

D/MS3101

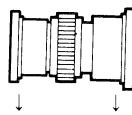

D/MS3102

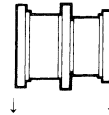

D/MS3106

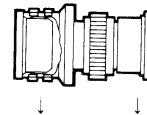

D/MS3108

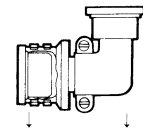

Connctorsize	Mating side	Rear side	Mating side	Rear side	Mating side	Rear side	Mating side	Rear side
10SL	-410R	-410R	-410R	-410R	-410Y	-410R	-410Y	-410R
12S	-412R	-410R	-412R		-412Y	-410R	-412Y	-410R
14S	-414R	-412R	-414R	-412R	-414Y	-412R	-414Y	-412R
16S, 16	-416R	-414R	-416R	-414R	-416Y	-414R	-416Y	-414R
18	-418R	-416R	-418R	-416R	-418Y	-416R	-418Y	-416R
20	-420R	-420Y	-420R	-418R	-420Y	-420Y	-420Y	-420Y
22	-422R	-420Y	-422R	-420R	-422Y	-420Y	-422Y	-420Y
24	-424R		-424R	-422R	-424Y		-424Y	
28	-428R		-428R		-428Y		-428Y	
32	-432R	-428R	-432R		-432Y	-428R	-432Y	-428R
36	-436R	-432R	-436R		-436Y	-432R	-436Y	-432R

Adapters

A
D/MS

D/MS3055-□□-□

Material/Finish.....Aluminum alloy/Zinc Plating, Trivalent chromate finish (Black)

P/N	A Thread	B Thread	C	D	E
D/MS3055-18-8□	1 - 20 UNEF - 2B	7/8 - 20 UNEF - 2A	30	20.4	12
D/MS3055-18-10□	1 - 20 UNEF - 2B	7/8-20 UNEF - 2A	30	22.4	12
D/MS3055-22-8□	1 3/16 -18 UNEF - 2B	7/8 - 20 UNEF - 2A	35	22.2	12
D/MS3055-22-8L□	1 3/16 -18 UNEF - 2B	7/8 - 20 UNEF - 2A	35	28.5	12
D/MS3055-22-12□	1 3/16 -18 UNEF - 2B	1 3/16 - 18 UNEF-2A	35	22.3	12
D/MS3055-28-16□	1 7/16 - 18 UNEF - 2B	1 7/16 - 18 UNEF - 2A	41	22.4	12

