

Housings, Power and Signal Cables, Connector Adapters

Housing E1341-01 (For E5859 series socket assemblies)



TACCF0177

The E1341-01 is a metal housing designed for 51 mm (2") diameter head-on photomultiplier tubes operated at room temperature. The E1341-01 ensures complete light-shielding and also accommodates a magnetic shield case (E989-62 sold separately).

The E1341-01 housing can be easily attached to a monochromator by preparing a simple adapter. The Copal No. 3 shutter can be directly attached to the E1341-01.

Dimensional Outlines (Unit: mm)

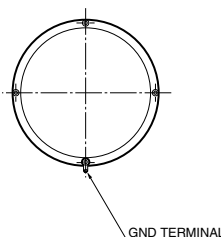
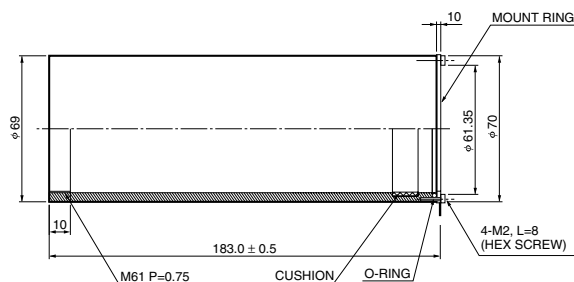

CAP (SUPPLIED)

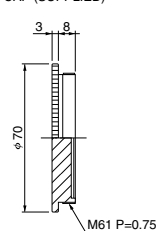

MOUNT FLANGE (SUPPLIED)

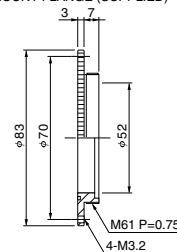

TACCA0228EB

Power and Signal Cables E1168 Series, Connector Adapters A4184 Series



TACCF0153

Hamamatsu offers the E1168 series cables for connection of photomultiplier tube assemblies and their accessories. A variety of cables are available, for handling high voltage, low voltage and signals.

In addition, Hamamatsu also provides the A4184 series connector adapters designed for SHV/MHV connector conversion.

Selection Guide

● For High Voltage

Type. No.	Cable Type	Cable Diameter	Maximum Voltage	Connector Types
E1168	RG-59B/U (Red)	φ6.2 mm	2.3 kV	MHV-P—MHV-P
E1168-10				MHV-P—SHV-P
E1168-17				SHV-P—SHV-P
E1168-18	Custom High Voltage Cable (Red)	φ6.15 mm ±0.3 mm	5 kV	MHV-P—MHV-P
E1168-19				SHV-P—SHV-P
E1168-20				MHV-P—SHV-P

● For Low Voltage

Type. No.	Cable Type	Connector Types
E1168-13	MVVS 3 × 0.3	MC-032—MC-032
E1168-14	MVVS 2 × 0.3	SR30-10PQ-4P—SR30-10PQ-4P

● For Signal

Type. No.	Cable Type	Impedance	Connector Types
E1168-01	3D-2V	50 Ω	N-P—N-P
E1168-02			N-P—BNC-P
E1168-03	3C-2V	75 Ω	BNC-P—BNC-P
E1168-05	3D-2V	50 Ω	BNC-P—BNC-P

● Connector Adapters

Type. No.	Connector Types
A4184-02	MHV Plug—SHV Jack
A4184-03	SHV Plug—MHV Jack

● Relay Adapters

Type. No.	Connector Types
A5074	SHV Jack—SHV Jack
A7992	BNC Jack—BNC Jack