



Copyright FCI.

A

B

C

D

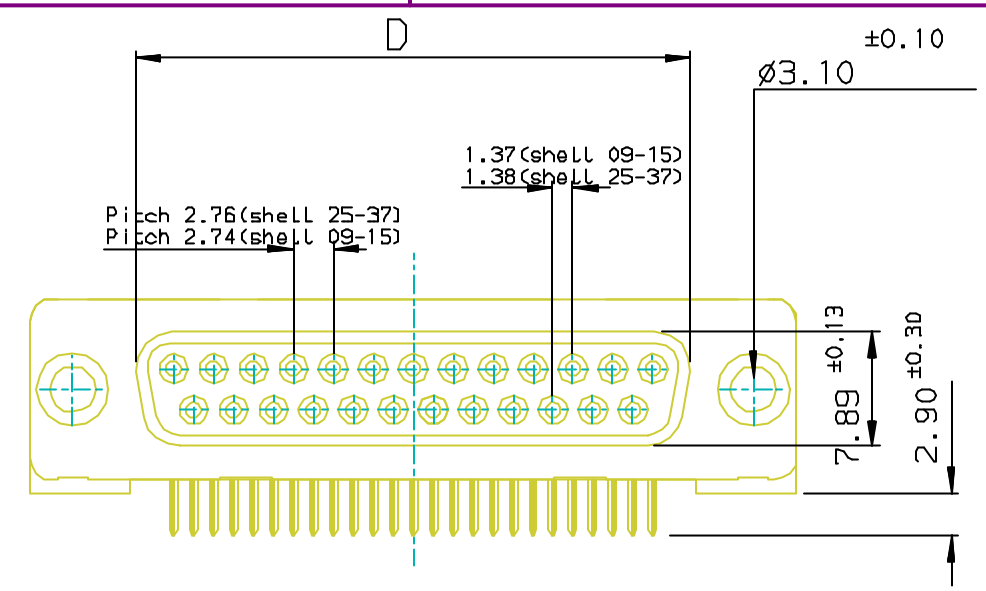
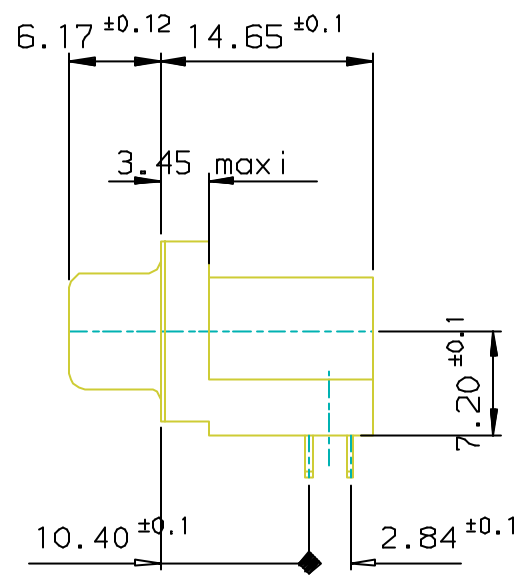
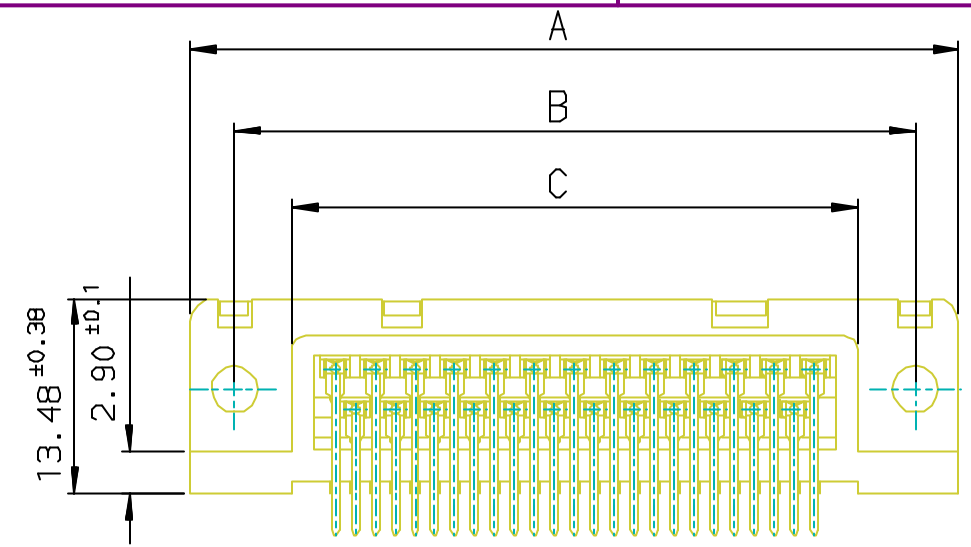

PC card drilling dimensions (after plating)
(thickness 1.60±0.20mm)

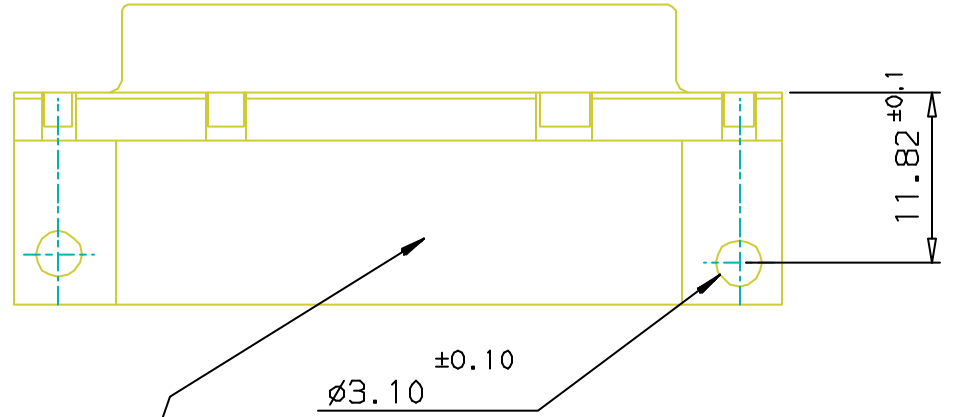
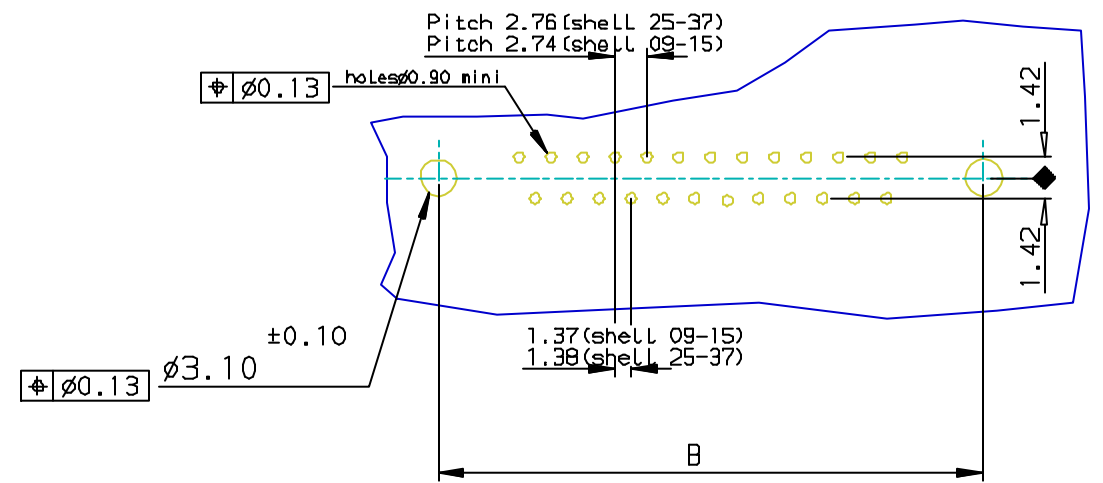

Part Number & Date Code Printing

SHELL	A±0.38	B±0.12	C±0.10	D±0.25	PART NUMBER
09	30.81	24.99	16.96	16.21	D09523A*PA00**
15	39.14	33.32	25.18	24.54	D15523A*PA00**
25	53.03	47.04	39.12	38.25	D25523A*PA00**
37	69.32	63.50	55.68	54.71	D37523A*PA00**

LF FOR LEAD FREE

Plating: 4 --> flash AU
Plating: 6 --> 0.76µ AU

FOR ROHS DETAILS REFER DWG.NO:C01-8646-0000

REQUIREMENTS

Technical characteristics:
 Shell: steel tin/Zinc Cr3 plated
 Insulators: self-extinguishing thermoplastic ,ULclass94V0
 Contacts size 20: phosphor bronze ,gold on mating end, bright tin on termination end over nickel on entire contact
 Cycles :500 for plating 6
 Cycles :200 for plating 4

Electrical characteristics:
 max.current rating:5A
 Test voltage:1000V
 Rated voltage:300V
 Contact resistance:≤15ma
 Shell resistance:≤5ma
 Insulation resistance:≥5000Ma

Climatic characteristics:
 Operating temperature range:-55°C +125°C

Dimensions:
 in accordance with MIL-C-24308

European Views

rev	ecn no	dr	date
B	105-0124	JS	2005/07/27
C	106-0074	SK	2006/06/08
-	-	-	-
-	-	-	-
-	-	-	-
-	-	-	-

www.fciconnect.com		surface ISO 1302 ✓	tolerance std ISO 406 ISO 1101	projection 	mm
TOLERANCES UNLESS OTHERWISE SPECIFIED					
Dr	JOHN SLEEBA	1997/03/20	ANGULAR	0.X	±0.1
Eng	GEORGE VJ	1997/03/20	LINEAR	0.XX	±0.1
Chr	GEORGE VJ	2005/07/27	0.XX* ±1*	0.XXX	±0.1
Appr	KVSD	2005/07/27	Product family	D-SUB	Spec ref -
FCI		title SOCKET CONNECT.DELTA D right angle spill without accessories.		dwg no C01-8646-0538	Rev. C
		catalog no DELTA-D		CUSTOMER	sheet 1 of 1

REV F - 2006-04-17