

Copyright FCI.
FCI

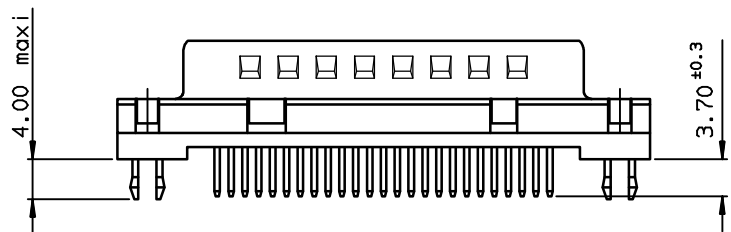
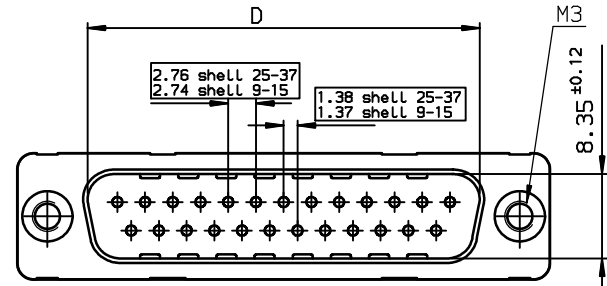
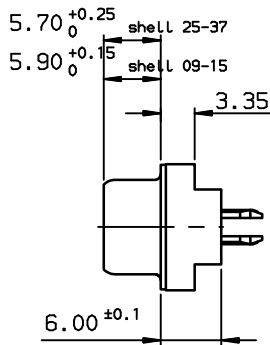
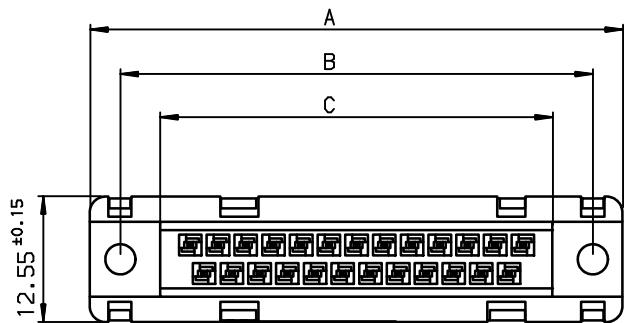

TIN LEAD PART NUMBER

SHELL	A±0.38	B±0.12	C±0.10	D±0.25	E±0.07	PART NUMBER
09	30.81	24.99	16.96	16.79	10.96	D09P24B.GL00
15	39.14	33.32	25.18	25.12	19.18	D15P24B.GL00
25	53.03	47.04	39.12	38.84	33.12	D25P24B.GL00
37	69.32	63.50	55.68	55.30	49.68	D37P24B.GL00

Protection: 4 --> flash AU
6 --> 0.76µ AU

LEAD FREE PART NUMBER

SHELL	A±0.38	B±0.12	C±0.10	D±0.25	E±0.07	PART NUMBER
09	30.81	24.99	16.96	16.79	10.96	D09P24B.GL00LF
15	39.14	33.32	25.18	25.12	19.18	D15P24B.GL00LF
25	53.03	47.04	39.12	38.84	33.12	D25P24B.GL00LF
37	69.32	63.50	55.68	55.30	49.68	D37P24B.GL00LF

Protection: 4 --> flash AU
6 --> 0.76µ AU

PC card drilling dimensions(after plating)
(thickness 2.40±0.20mm)

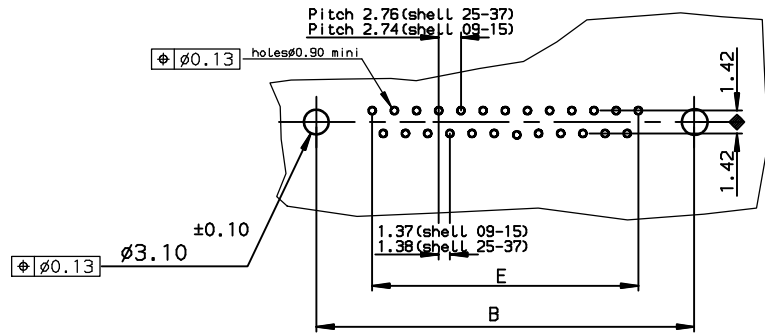

rev	ecn no	dr	date
B	-	-	1996/09/09
C	LS05-001	MPE	2005/03/10
D	LS05-0056	MPE	2005/06/27
E	LS06-0097	LGO	2006/07/29
-	-	-	-
-	-	-	-
-	-	-	-

GENERAL CHARACTERISTICS AND ROHS INFORMATIONS:
SEE DRAWING C01-8646-0000

www.fciconnect.com		surface ISO 1302 ✓	tolerance std ISO 406 ISO 1101	projection mm
TOLERANCES UNLESS OTHERWISE SPECIFIED				
Dr	LELEON	1992/09/14	ANGULAR	LINEAR
Eng	PESSON	1992/09/14	0.X	±0.1
Chr	LEGARE	1992/09/14	0.XX	±0.1
Appr	LEGARE	1992/09/14	0.XXX	±0.1
Product family			D-SUB	Spec ref -
title MALE CONNECTOR DELTA D ST		size A3		Scale 2
straight,solder type for		ECN		LS06-0097
catalog no		C01-8646-0106		Rev. E
		CUSTOMER		sheet 1 of 1

European Views