

Quartz Crystal

Holder Code V, GLASS SEALED CERAMIC 8 X 4.5MM Surface Mount Package

FEATURE

- Ultra thin, thickness 1.0mm
- Leadless type
- High precision characteristic covering up to high frequency range
- Automatic mounting
- Embossed taping specification
- Reflow soldering
- Lead Free & RoHS Compliant

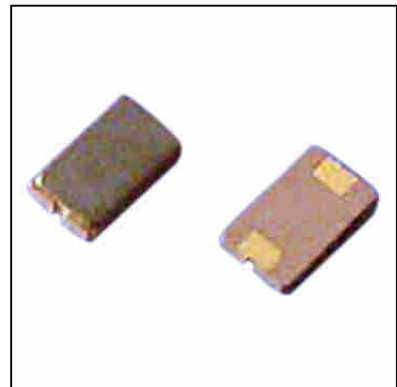

ELECTRICAL SPECIFICATIONS

Output Frequency Range	8.000 MHz to 80.000 MHz
Mode	see Table 1*
Frequency Tolerance (at 25°C)	±10ppm ~ ±50ppm Max
Frequency Stability Over Operating Temperature Characteristics	-10°C ~+60°C ±30ppm, -20°C ~+70°C ±50ppm or specify
Storage Temperature Range	-55 °C to +125 °C
Operable Temperature Range	-10°C to +60°C ~ -40°C to +85 °C
Shunt Capacitance (C ₀)	5.0 pF Max
Driver Level (Typical)	100µW
Load Capacitance(C _L)	Series, 16pF, 20pF, 30pF, 32pF, or specify
Equivalent Series Resistance ESR (Ω)	see Table 1*
Aging @25°C 1 st year (Max)	±3ppm, ±5ppm/year
Shock Resistance	Drop test of 3 times on 2mm stainless plate from 75cm height

REMARK: SPECIFICATIONS SUBJECT TO CHANGE WITHOUT PRIOR NOTICE. PLEASE CONFIRM WITH OUR SALES ENGINEER.

Frequency and Equivalent Series Resistant

Frequency Range	E.S.R. (Ω)	Mode
8.000 MHz ~ 10.000 MHz	70 Max	Fundamental / AT
10.000 MHz ~ 40.000 MHz	40 Max	Fundamental / AT
30.000 MHz ~ 45.000 MHz	60 Max	Third Overtone / AT
45.000 MHz ~ 80.000 MHz	50 Max	Third Overtone / AT

Dimension

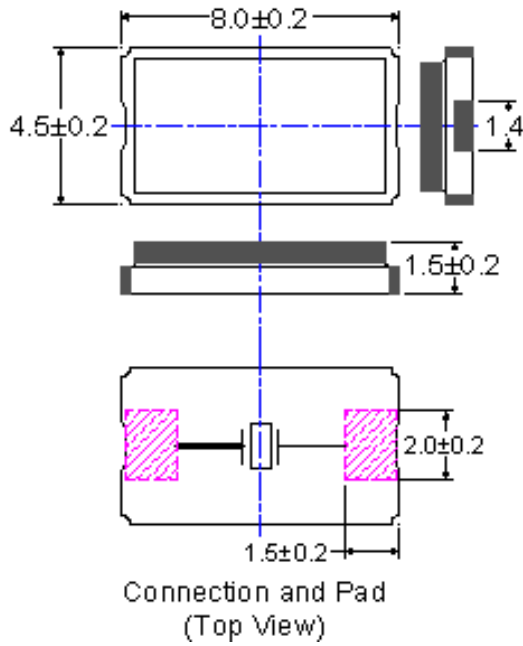

Reference Land Pattern

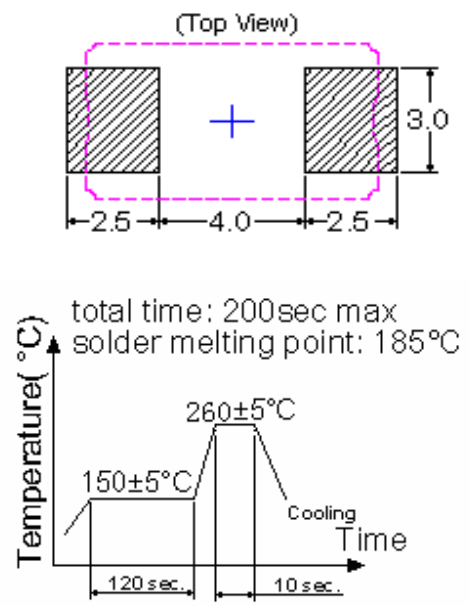

PACKING

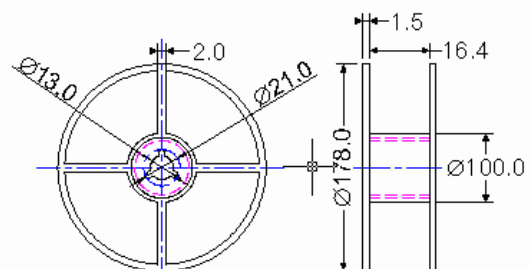
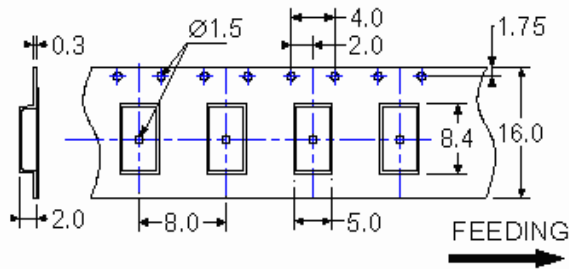

CRYSTAL PART NUMBER SYSTEM

HOLDER DESCRIPTION	CODE
CERAMIC 8.0X4.5mm SMT	V

PART NUMBER EXPLANATION - HOW TO ORDER		
D3V5795-17305EFB-G	3,5795MHZ 17PF 30PPM/50PPM FUNDAMENTAL BULK (ROHS COMPLIANT)	
D	DB LECTRO Inc.	
3V5795	FIRST FIVE NUMBERS OF THE FREQUENCY WITH HOLDER CODE AT DECIMAL POINT	
-	"-" REGULAR PACKAGE "I" ISOLATED WITH WASHER "V" VINYL SLEEVE "C" CUT LEAD "T" THIRD LEG GROUND	
17	LOAD CAPACITANCE (17PF)	
30	FREQUENCY TOLERANCE (30PPM)	
5	FREQUENCY STABILITY AT OPERATING TEMPERATURE:	
E	OPERATING TEMPERATURE RANGE "E" EXTENDED TEMP. -40°C+85°C "Blank" TYPICAL TEMP. -20°C+70°C "A" STANDARD TEMP. -10°C+60°C	0=5PPM 1=10PPM 2=20PPM 3=30PPM 5=50PPM (TYPICAL) 6=100PPM
F	"F" FUNDAMENTAL "T" THIRD OVERTONE "5" FIFTH OVERTONE "7" SEVENTH OVERTONE	
B	"B" BULK "T" TAPE / REEL "G" TAPE / REEL / GULLWING "C" TAPE / REEL / CRIMPED LEADS	
G	ROHS COMPLIANT	