

ALTERNATOR DIODE FOR AUTOMOTIVE APPLICATION.

#### FEATURES

- Average Forward Current :  $I_0=30A$ .

#### POLARITY

E30A27VS E30A27VR

(+ Type) (- Type)

#### MAXIMUM RATING ( $T_a=25^\circ C$ )

CHARACTERISTIC	SYMBOL	RATING	UNIT
DC Reverse Voltage	$V_{DC}$	24	V
Average Forward Current	$I_{F(AV)}$	30	A
Peak 1 Cycle Surge Current	$I_{FSM}$	250 (50Hz)	A
Non-Repetitive Reverse 1 Cycle Surge Current	$I_{RSM}$	50	A
Junction Temperature	$T_j$	-40 ~ 150	$^\circ C$
Storage Temperature Range	$T_{stg}$	-40 ~ 150	$^\circ C$

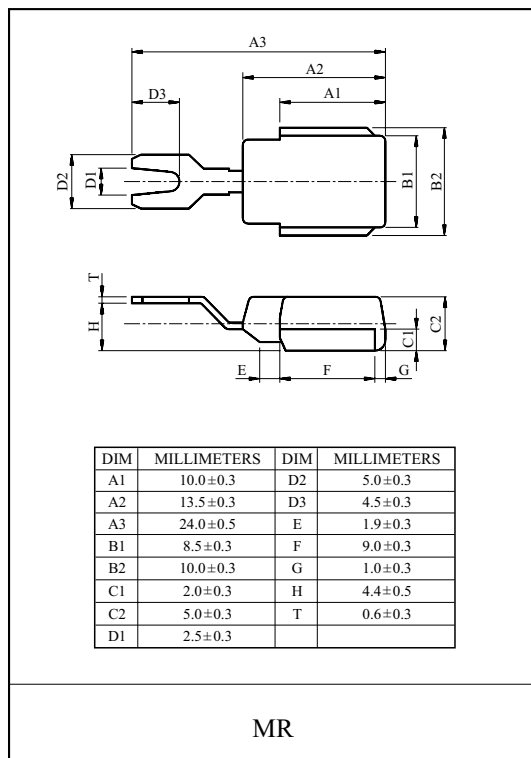

#### ELECTRICAL CHARACTERISTICS ( $T_a=25^\circ C$ )

CHARACTERISTIC	SYMBOL	TEST CONDITION	MIN.	TYP.	MAX.	UNIT
Zener Voltage	$V_Z$	$I_Z=10mA$	24	-	30	V
Peak Forward Voltage	$V_{FM}$	$I_{FM}=100A$	-	-	1.2	V
Repetitive Peak Reverse Current	$I_{RRM}$	$V_{RRM}=24V$	-	-	50	$\mu A$
Zener Voltage Temperature Coefficient	$r_Z$	$I_Z=10mA$	23	-	36	mV/ $^\circ C$
Reverse Recovery Time	$t_{rr}$	$I_F=0.1A, I_R=0.1A$	-	-	15	$\mu S$
Temperature Resistance	$R_{th}$	DC total junction to case	-	-	1.0	$^\circ C/W$

# E30A27VS, E30A27VR

