

## Cemented Resistors with Corrugated Ribbon

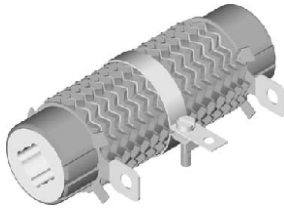

### FEATURES

- All welded construction
- Power rating up to 500 Watt
- Corrugated ribbon construction aids rapid cooling
- Available in adjustable design = "E"

STANDARD ELECTRICAL SPECIFICATIONS					
MODEL	POWER RATING $P_{40\text{ }^\circ\text{C}}$ W	RESISTANCE RANGE $\pm 10\% \pm 5\%$			WEIGHT (grams)
		TCR + 650 ... + 750 ppm/K WM10	TCR - 10 ... - 80 ppm/K WM50	TCR + 100 ... + 180 ppm/K WM110	
ZBS 20/100 ZBS 20/100 E	50	R13 - R51	R56 - 2R2	1R3 - 6R2	100
ZBS 20/165 ZBS 20/165 E	100	R27 - 1R0	1R1 - 4R7	2R4 - 12R	150
ZBS 20/265 ZBS 20/265 E	150	R47 - 1R8	2R0 - 7R5	4R3 - 22R	250
ZBS 30/100 ZBS 30/100 E	75	R10 - R43	R47 - 3R3	1R0 - 8R2	200
ZBS 30/133 ZBS 30/133 E	110	R15 - R62	R68 - 5R1	1R5 - 12R	250
ZBS 30/165 ZBS 30/165 E	150	R20 - R91	1R0 - 6R8	2R0 - 16R	300
ZBS 30/215 ZBS 30/215 E	200	R27 - 1R1	1R2 - 9R1	2R7 - 24R	400
ZBS 30/265 ZBS 30/265 E	250	R30 - 1R3	1R5 - 11R	3R9 - 27R	500
ZBS 30/330 ZBS 30/330 E	300	R39 - 1R8	2R0 - 15R	5R1 - 36R	600
ZBS 45/370 ZBS 45/370 E	375	R75 - 3R0	3R3 - 24R	8R2 - 56R	1000
ZBS 60/370 ZBS 60/370 E	500	R91 - 3R9	4R3 - 33R	10R - 75R	1200

GLOBAL PART NUMBER INFORMATION																	
New Global Part Numbering: ZBS202S01100KLX000 (preferred part number format)																	
Z	B	S	2	0	2	S	0	1	1	0	0	K	L	X	0	0	0
MODEL	SIZE	SPECIAL CHARACTER	TCR/MATERIAL		VALUE	TOLERANCE	PACKING	SPECIAL									
ZBS	202S =20/100 204L =20/165 207D =20/265 302S =30/100 303P =30/133 304L =30/165 305Z =30/215 307D =30/265 308D =30/303 3096 =30/330 45AA =45/370 60AA =60/370	0 = neutral 1 = E Z = value overflow (BV)	1 = - 10 ... - 80 ppm/K WM50 Class 1 3 = 100 ... 180 ppm/K WM110 Class 3 4 = 650 ... 750 ppm/K WM10 Class 1 0 = SWI		2 digit value 1 digit multiplier Multiplier: 8 = $\times 10^{-2}$ 9 = $\times 10^{-1}$ 0 = $\times 10^0$	J = $\pm 5.0\%$ K = $\pm 10.0\%$	(see Packing table)	The 5 digit BV number will be encoded using a 36 character code. This code contains numbers 0...9 and letters A...Z (36 characters total) and allows to encode at least 46 655 five digit BV numbers. 000 = standard									
Historical Part Number example: ZBS 20/100 50 10R 10% (will continue to be accepted)																	
ZBS 20/100		50		10R		10%											
HISTORICAL MODEL		TCR/MATERIAL		VALUE		TOLERANCE											

PACKING TABLE		
SAP	DESCRIPTION	TYPE
LX	Loose pack, without quantity	all
ZX	Special pack (with BV #), without quantity <b>Note:</b> LX = B29 on Dale legacy ZX = S51 on Dale legacy	all

**DIMENSIONS**

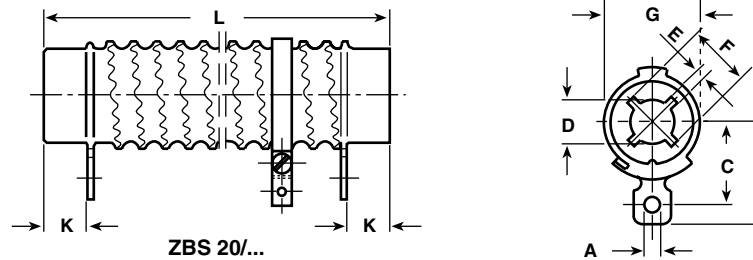

MODEL	DIMENSIONS in millimeters [inches]								
	L	K	A	B	C	D	E	F	G
ZBS 20/100	100 ± 2.5	15	4.2	26.5	22	10	1.5	14	24
ZBS 20/100 E	[3.937 ± 0.098]	[0.591]	[0.165]	[1.043]	[0.866]	[0.394]	[0.059]	[0.551]	[0.945]
ZBS 20/165	165 ± 4	15	4.2	26.5	22	10	1.5	14	24
ZBS 20/165 E	[6.496 ± 0.157]	[0.591]	[0.165]	[1.043]	[0.866]	[0.394]	[0.059]	[0.551]	[0.945]
ZBS 20/265	265 ± 6.6	15	4.2	26.5	22	10	1.5	14	24
ZBS 20/265 E	[10.433 ± 0.260]	[0.591]	[0.165]	[1.043]	[0.866]	[0.394]	[0.059]	[0.551]	[0.945]

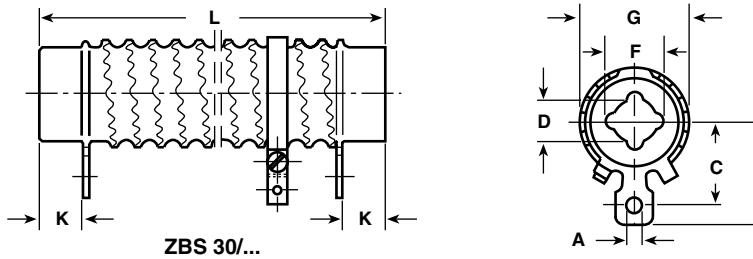

MODEL	DIMENSIONS in millimeters [inches]							
	L	K	A	B	C	D	F	G
ZBS 30/100	100 ± 2.5	15	5.2	34	28	14	18.5	37 ± 1
ZBS 30/100 E	[3.937 ± 0.098]	[0.591]	[0.205]	[1.339]	[1.102]	[0.551]	[0.728]	[1.457 ± 0.039]
ZBS 30/133	133 ± 3.3	15	5.2	34	28	14	18.5	37 ± 1
ZBS 30/133 E	[5.236 ± 0.130]	[0.591]	[0.205]	[1.339]	[1.102]	[0.551]	[0.728]	[1.457 ± 0.039]
ZBS 30/165	165 ± 4	15	5.2	34	28	14	18.5	37 ± 1
ZBS 30/165 E	[6.496 ± 0.157]	[0.591]	[0.205]	[1.339]	[1.102]	[0.551]	[0.728]	[1.457 ± 0.039]
ZBS 30/215	215 ± 5.4	15	5.2	34	28	14	18.5	37 ± 1
ZBS 30/215 E	[8.465 ± 0.213]	[0.591]	[0.205]	[1.339]	[1.102]	[0.551]	[0.728]	[1.457 ± 0.039]
ZBS 30/265	265 ± 6.6	15	5.2	34	28	14	18.5	37 ± 1
ZBS 30/265 E	[10.433 ± 0.260]	[0.591]	[0.205]	[1.339]	[1.102]	[0.551]	[0.728]	[1.457 ± 0.039]
ZBS 30/330	330 ± 8	15	5.2	34	28	14	18.5	37 ± 1
ZBS 30/330 E	[12.992 ± 0.315]	[0.591]	[0.205]	[1.339]	[1.102]	[0.551]	[0.728]	[1.457 ± 0.039]

**DIMENSIONS (CONTINUED)**

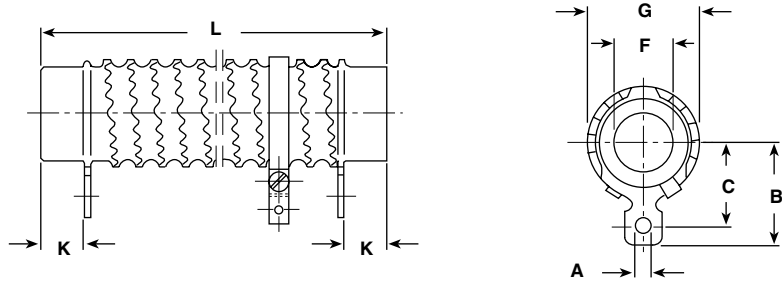

ZBS 45/370, ZBS 60/370

MODEL	DIMENSIONS in millimeters [inches]						
	L	K	A	B	C	F	G
ZBS 45/370	370 ± 9	15	5.2	42.5	37	30	52 ± 1
ZBS 45/370 E	[14.567 ± 0.354]	[0.591]	[0.205]	[1.673]	[1.457]	[1.181]	[2.047 ± 0.039]
ZBS 60/370	370 ± 9	15	5.2	51.5	45.5	45	67 ± 1
ZBS 60/370 E	[14.567 ± 0.354]	[0.591]	[0.205]	[2.028]	[1.791]	[1.772]	[2.638 ± 0.039]

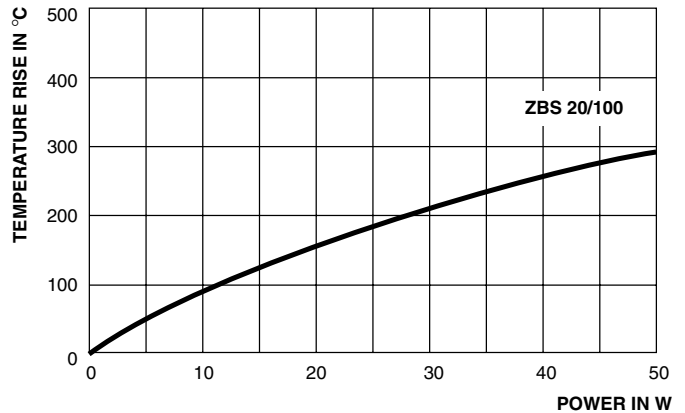
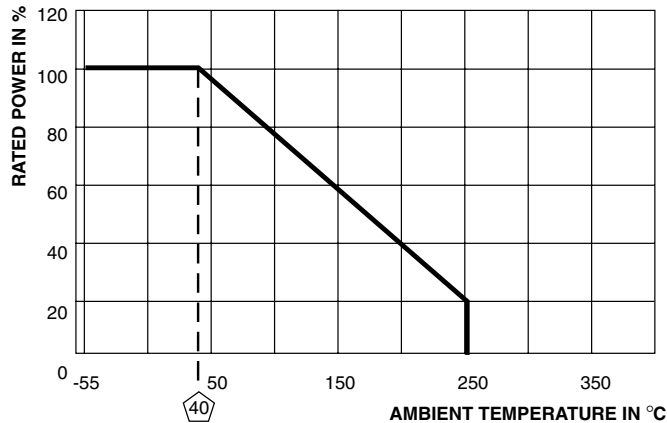

**Derating**

**Temperature Rise**

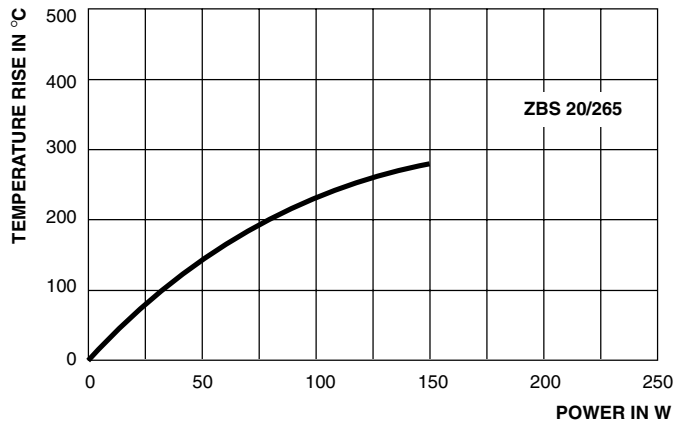
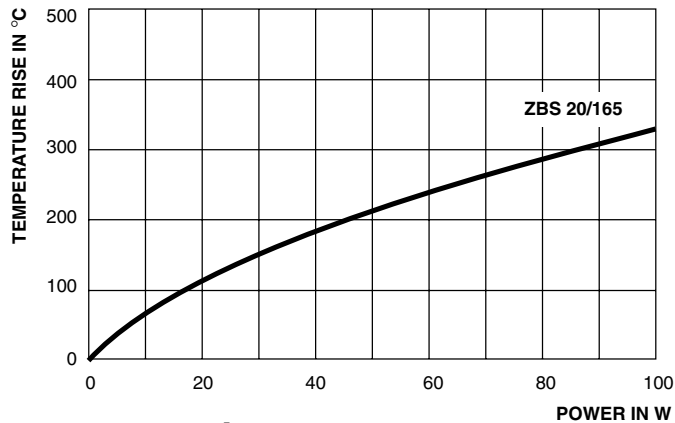

**Temperature Rise**

**Temperature Rise**

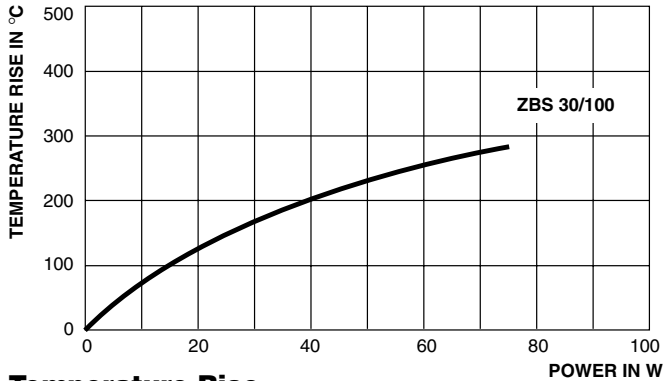

Temperature Rise

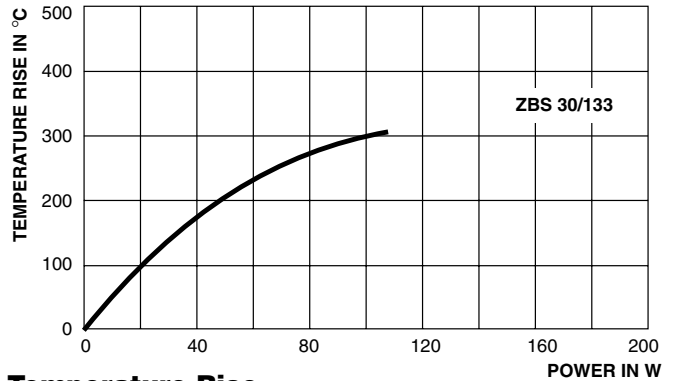

Temperature Rise

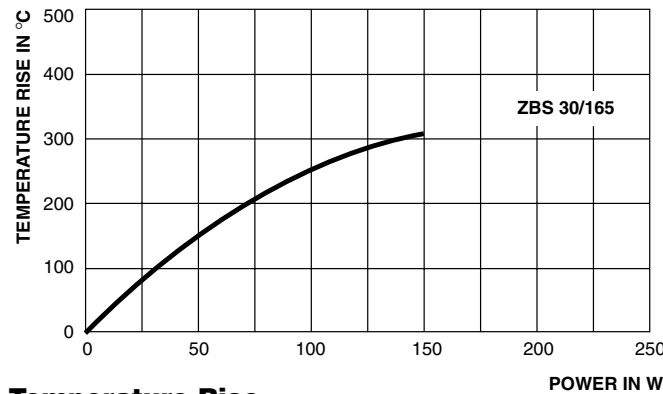

Temperature Rise

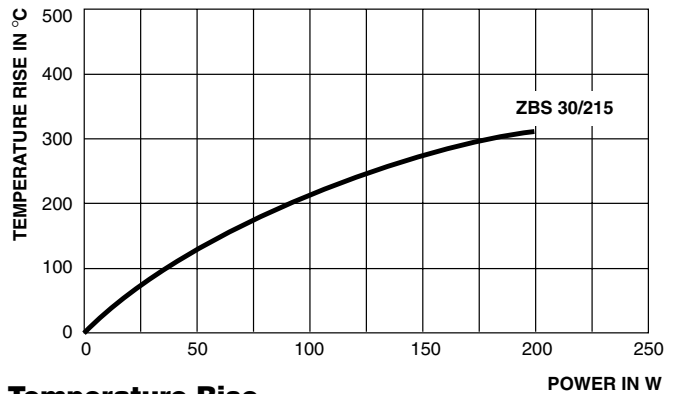

Temperature Rise

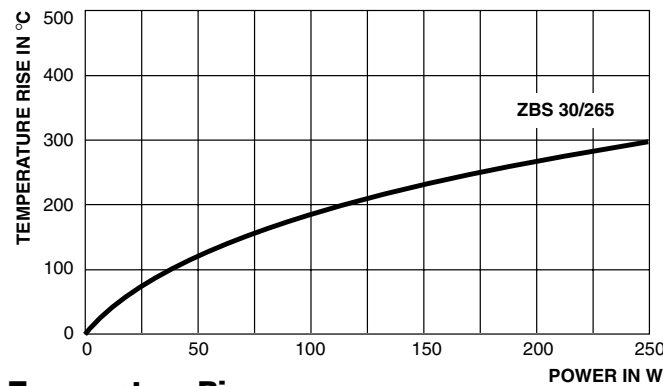

Temperature Rise

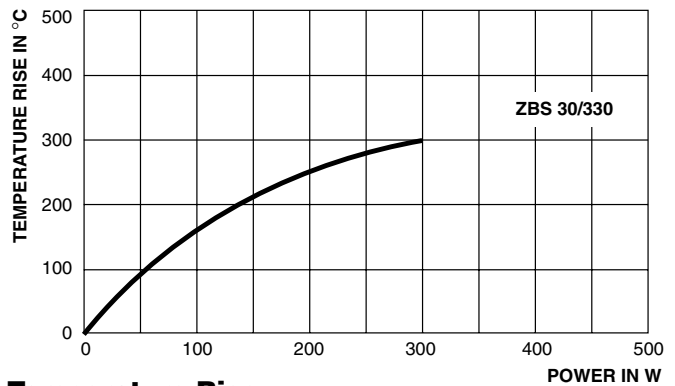

Temperature Rise

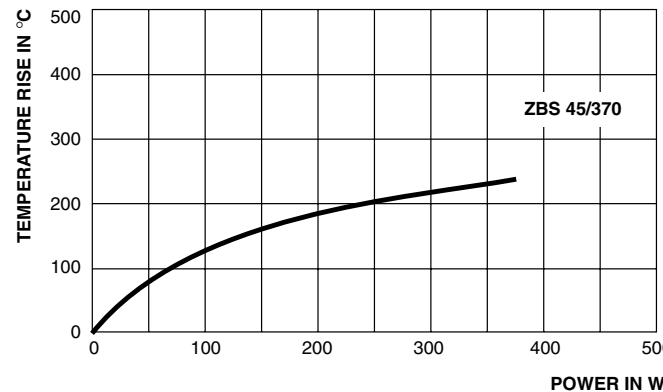

Temperature Rise

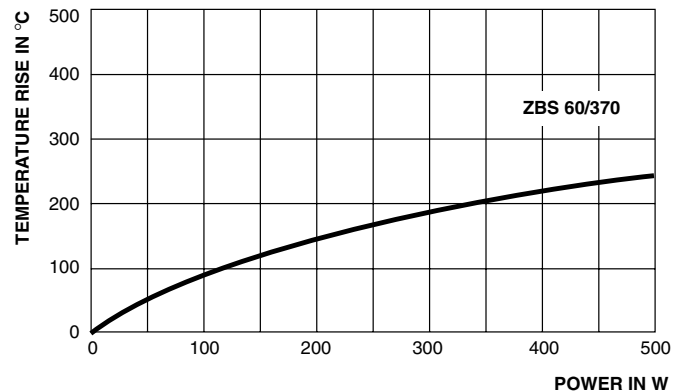

Temperature Rise



### Notice

Specifications of the products displayed herein are subject to change without notice. Vishay Intertechnology, Inc., or anyone on its behalf, assumes no responsibility or liability for any errors or inaccuracies.

Information contained herein is intended to provide a product description only. No license, express or implied, by estoppel or otherwise, to any intellectual property rights is granted by this document. Except as provided in Vishay's terms and conditions of sale for such products, Vishay assumes no liability whatsoever, and disclaims any express or implied warranty, relating to sale and/or use of Vishay products including liability or warranties relating to fitness for a particular purpose, merchantability, or infringement of any patent, copyright, or other intellectual property right.

The products shown herein are not designed for use in medical, life-saving, or life-sustaining applications. Customers using or selling these products for use in such applications do so at their own risk and agree to fully indemnify Vishay for any damages resulting from such improper use or sale.