

PC card drilling dimensions (after plating)
(thickness 1.60±0.20mm)

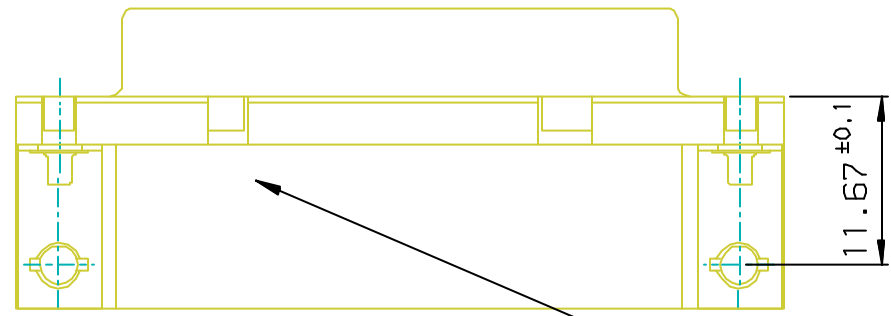

Part Number & Date Code Printing

SHELL	A±0.38	B±0.12	C±0.10	D±0.25	PART NUMBER	
09	30.81	24.99	16.96	16.21	D09S13A4GA00**	D09S13A6GA00**
15	39.14	33.32	25.18	24.54	D15S13A4GA00**	D15S13A6GA00**
25	53.03	47.04	39.12	38.25	D25S13A4GA00**	D25S13A6GA00**
37	69.32	63.50	55.68	54.71	D37S13A4GA00**	D37S13A6GA00**
					Gold flash	0,76 µ gold

LF FOR LEAD FREE

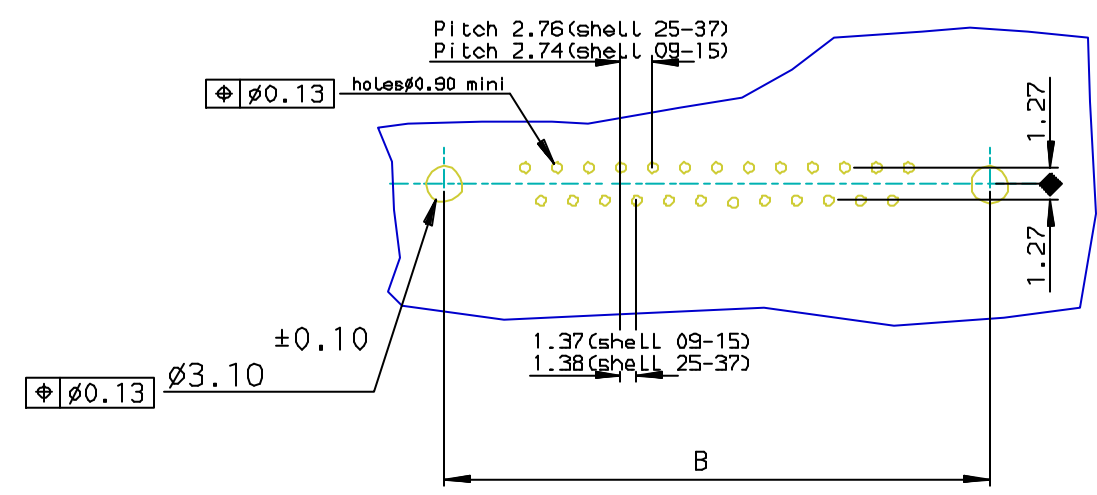

FOR ROHS DETAILS REFER DWG.NO: C01-8646-0000

European Views

REQUIREMENTS

Technical characteristics:
 Shell: steel tin/Zinc Cr3 plated
 Insulators: self-extinguishing black polyster, UL class 94V0
 Contacts size 20, brass, gold on mating end, bright tin on termination end over nickel on entire contact
 Cycles: 500 for plating 6
 200 for plating 4
 Harpoons: brass, tin plated
 Metal plate for electrical continuity: brass, tin/Zinc Cr3 plated

Electrical characteristics:
 max. current rating: 5A
 Test voltage: 1000V
 Rated voltage: 300V
 Contact resistance: <15mΩ
 Shell resistance: <5mΩ
 Insulation resistance: >5000MΩ

Climatic characteristics:
 Operating temperature range: -55°C +125°C

Dimensions:
 in accordance with MIL-C-24308

www.fciconnect.com		surface ISO 1302 ✓	tolerance std ISO 406 ISO 1101	projection mm
TOLERANCES UNLESS OTHERWISE SPECIFIED				
Dr	JOHN SLEEBA	2000/12/22	ANGULAR	LINEAR
Eng	GEORGE VJ	2000/12/22	0.X	±0.1
Chr	GEORGE VJ	2005/07/27	0.XX	±0.1
Appr	KVSD	2005/07/27	0.XXX	±0.1
Product family			D-SUB	
title			Spec ref -	
SOCKET CONNECTOR. DELTA D right angle			size A3	
with harpoon, metal plate.			Scale 1:1	
catalog no DELTA-D			ECN -	
Rev. C			C01-8646-0757	
CUSTOMER			sheet 1 of 1	

rev	ecn no	dr	date
B	105-0124	JS	2005/07/27
C	106-0074	SK	2006/06/08
-	-	-	-
-	-	-	-
-	-	-	-
-	-	-	-



Copyright FCI.