

| SHELL | A±0.38 | B±0.12 | C±0.10 | D±0.25 | E±0.07 | PART NUMBER  |
|-------|--------|--------|--------|--------|--------|--------------|
| 09    | 30.81  | 24.99  | 16.96  | 16.79  | 10.96  | D09P34B.GX00 |
| 15    | 39.14  | 33.32  | 25.18  | 25.12  | 19.18  | D15P34B.GX00 |
| 25    | 53.03  | 47.04  | 39.12  | 38.84  | 33.12  | D25P34B.GX00 |
| 37    | 69.32  | 63.50  | 55.68  | 55.30  | 49.68  | D37P34B.GX00 |

Protection: 4 --> flash AU  
6 --> 0.76µ AU

PC card drilling dimensions (after plating)  
(thickness 2.40±0.20mm)

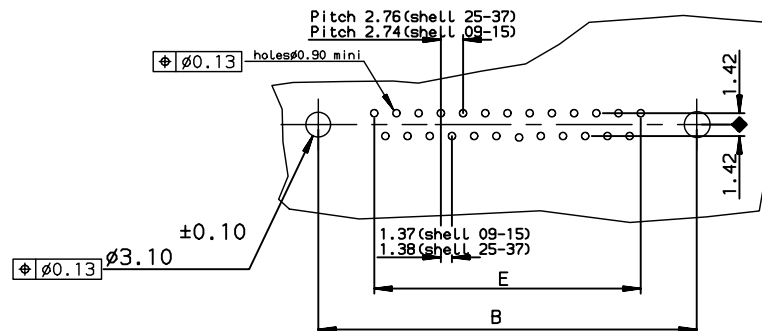

**REQUIREMENTS**

Technical characteristics:

Shell: steel tin plated  
Insulators: self-extinguishing thermoplastic, UL class 94V0  
Contacts size 20: phosphor bronze, gold on mating end, bright tin on termination end over nickel on entire contact  
Cycles: >500 for protection 6  
>200 for protection 4

Accessories:

Threaded inserts: 4.40 with harpoon, tin plated  
retention against torque 0.70N.m minimum

Electrical characteristics:

max. current rating: 5A  
Test voltage: 1000V  
Rated voltage: 300V  
Contact resistance: <10ma  
Shell resistance: <5ma  
Insulation resistance: >5000Ma

Climatic characteristics:

Operating temperature range: -55°C +125°C

Dimensions:

In accordance with MIL-C-24308C and DIN41652

| rev | ecn no    | dr  | date       |
|-----|-----------|-----|------------|
| A   | -         | MPE | 1995/09/15 |
| B   | LS07-0094 | MPE | 2007/04/06 |
| -   | -         | -   | -          |
| -   | -         | -   | -          |
| -   | -         | -   | -          |
| -   | -         | -   | -          |

|                                       |        |            |                           |                                   |                       |
|---------------------------------------|--------|------------|---------------------------|-----------------------------------|-----------------------|
| www.fciconnect.com                    |        |            | surface<br>ISO 1302 ✓     | tolerance std<br>ISO 406 ISO 1101 | projection<br>mm      |
| TOLERANCES UNLESS OTHERWISE SPECIFIED |        |            |                           |                                   |                       |
| Dr                                    | PESSON | 1995/09/15 | ANGULAR                   | 0.X ± 0.1                         | size A3 Scale 2       |
| Eng                                   | PESSON | 1995/09/15 | LINEAR                    | 0.XX ± 0.1                        | ECN LS07-0094         |
| Chr                                   | LEGARE | 1995/09/15 | 0.XX ± 2'                 | 0.XXX ± 0.1                       | Spec ref -            |
| Appr                                  | LEGARE | 1995/09/15 | Product family            | SUB                               |                       |
| FCJ                                   |        |            | CRS MALE DELTA D STRAIGHT |                                   | Rev. B                |
|                                       |        |            | SOLDER TYPE FOR PCB 2.4mm |                                   | C01-8646-0368         |
| catalog no                            |        |            | -                         |                                   | CUSTOMER sheet 1 of 1 |