



# SAW Components

Data Sheet B4140





**SAW Components**

**B4140**

**Low-Loss Filter for Mobile Communication**

**897,50 MHz**

**Data Sheet**



Ceramic package **DCC6D**

**Features**

- Low-loss RF filter for mobile telephone EGSM systems, transmit path
- Low amplitude ripple
- Usable passband 35 MHz
- Balanced to unbalanced Operation
- Impedance transformation from 200 Ω to 50 Ω
- Ceramic package for **Surface Mounted Technology (SMT)**

**Terminals**

- Ni, gold-plated

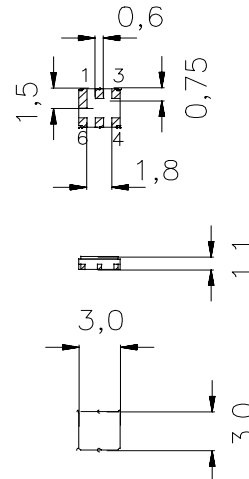

Dimensions in mm, approx. weight 0,037 g

**Pin configuration**

- 4, 6 Input, balanced
- 5 To be grounded
- 2 Output, unbalanced
- 1, 3 Output ground
- 1, 3, 5 Case ground

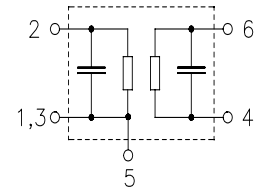

Type	Ordering code	Marking and Package according to	Packing according to
B4140	B39901-B4140-U510	C61157-A7-A68	F61074-V8089-Z000

Electrostatic Sensitive Device (ESD)

**Maximum ratings**

Operable temperature range	$T$	- 25/ + 80	°C	source impedance 50 Ω, load impedance 200 Ω, peak power of GSM signal, duty cycle 2 : 8 duty cycle 1: 8
Storage temperature range	$T_{stg}$	- 40 / + 85	°C	
DC voltage	$V_{DC}$	0	V	
Input power max. 880 ... 915 MHz	$P_{IN}$	8,5 10,0	dBm dBm	



**SAW Components**

**B4140**

**Low-Loss Filter for Mobile Communication**

**897,50 MHz**

**Data Sheet**



**Characteristics**

Operating temperature range:  $T = 25 \pm 2 \text{ }^\circ\text{C}$   
 Terminating source impedance:  $Z_S = 50 \text{ } \Omega$   
 Terminating load impedance:  $Z_L = 200 \text{ } \Omega \parallel 56 \text{ nH}$   
 ( L simulated with Q factor 20 )

			<b>min.</b>	<b>typ.</b>	<b>max.</b>	
<b>Center frequency</b>	$f_C$		—	897,5	—	MHz
<b>Maximum insertion attenuation</b>	$\alpha_{\max}$	880,0 ... 915,0 MHz	—	2,8	3,4	dB
<b>Amplitude ripple (p-p)</b>	$\Delta\alpha$	880,0 ... 915,0 MHz	—	1,2	1,5	dB
<b>Input VSWR</b>		880,0 ... 915,0 MHz	—	1,7	2,0	
<b>Output VSWR</b>		880,0 ... 915,0 MHz	—	1,6	2,0	
<b>Attenuation</b>	$\alpha$					
		0,0 ... 600,0 MHz	60	77	—	dB
		600,0 ... 800,0 MHz	50	72	—	dB
		800,0 ... 860,0 MHz	40	44	—	dB
		925,0 ... 935,0 MHz	9	14	—	dB
		935,0 ... 960,0 MHz	25	27	—	dB
		960,0 ... 1000,0 MHz	25	40	—	dB
		1000,0 ... 1050,0 MHz	40	64	—	dB
		1050,0 ... 1500,0 MHz	55	68	—	dB
		1500,0 ... 2000,0 MHz	50	70	—	dB
		2000,0 ... 3000,0 MHz	30	44	—	dB
		3000,0 ... 5000,0 MHz	18	29	—	dB
		5000,0 ... 6000,0 MHz	10	28	—	dB
<b>Symmetry in band</b> (referenced to the matched operating condition)						
	$ S_{31} / S_{21} $	880,0 ... 915,0 MHz	-1,0	0	1,0	dB
	$\arg(S_{31}/S_{21})$	880,0 ... 915,0 MHz	170	180	190	°



SAW Components

B4140

Low-Loss Filter for Mobile Communication

897,50 MHz

Data Sheet



**Characteristics**

Operating temperature range:  $T = +20$  to  $+40$  °C  
 Terminating source impedance:  $Z_S = 50 \Omega$   
 Terminating load impedance:  $Z_L = 200 \Omega \parallel 56 \text{ nH}$   
 ( L simulated with Q factor 20 )

			min.	typ.	max.	
<b>Center frequency</b>	$f_C$		—	897,5	—	MHz
<b>Maximum insertion attenuation</b>	$\alpha_{\max}$	880,0 ... 915,0 MHz	—	2,9	3,6	dB
<b>Amplitude ripple (p-p)</b>	$\Delta\alpha$	880,0 ... 915,0 MHz	—	1,3	1,7	dB
<b>Input VSWR</b>		880,0 ... 915,0 MHz	—	1,7	2,0	
<b>Output VSWR</b>		880,0 ... 915,0 MHz	—	1,6	2,0	
<b>Attenuation</b>	$\alpha$					
		0,0 ... 600,0 MHz	60	77	—	dB
		600,0 ... 800,0 MHz	50	72	—	dB
		800,0 ... 860,0 MHz	40	44	—	dB
		925,0 ... 935,0 MHz	9	13	—	dB
		935,0 ... 960,0 MHz	25	27	—	dB
		960,0 ... 1000,0 MHz	25	40	—	dB
		1000,0 ... 1050,0 MHz	40	64	—	dB
		1050,0 ... 1500,0 MHz	55	68	—	dB
		1500,0 ... 2000,0 MHz	50	70	—	dB
		2000,0 ... 3000,0 MHz	30	44	—	dB
		3000,0 ... 5000,0 MHz	18	29	—	dB
		5000,0 ... 6000,0 MHz	10	28	—	dB
<b>Symmetry in band</b> (referenced to the matched operating condition)						
	$ S_{31} / S_{21} $	880,0 ... 915,0 MHz	-1,0	0	1,0	dB
	$\arg(S_{31}/S_{21})$	880,0 ... 915,0 MHz	170	180	190	°



**SAW Components**

**B4140**

**Low-Loss Filter for Mobile Communication**

**897,50 MHz**

**Data Sheet**



**Characteristics**

Operating temperature range:  $T = +10$  to  $+60$  °C  
 Terminating source impedance:  $Z_S = 50 \Omega$   
 Terminating load impedance:  $Z_L = 200 \Omega \parallel 56$  nH  
 ( L simulated with Q factor 20 )

			<b>min.</b>	<b>typ.</b>	<b>max.</b>	
<b>Center frequency</b>	$f_C$		—	897,5	—	MHz
<b>Maximum insertion attenuation</b>	$\alpha_{max}$	880,0 ... 915,0 MHz	—	2,9	3,8	dB
<b>Amplitude ripple (p-p)</b>	$\Delta\alpha$	880,0 ... 915,0 MHz	—	1,3	1,9	dB
<b>Input VSWR</b>		880,0 ... 915,0 MHz	—	1,7	2,0	
<b>Output VSWR</b>		880,0 ... 915,0 MHz	—	1,6	2,0	
<b>Attenuation</b>	$\alpha$					
		0,0 ... 600,0 MHz	60	77	—	dB
		600,0 ... 800,0 MHz	50	72	—	dB
		800,0 ... 860,0 MHz	40	44	—	dB
		925,0 ... 935,0 MHz	8	12	—	dB
		935,0 ... 960,0 MHz	24	27	—	dB
		960,0 ... 1000,0 MHz	25	40	—	dB
		1000,0 ... 1050,0 MHz	40	64	—	dB
		1050,0 ... 1500,0 MHz	55	68	—	dB
		1500,0 ... 2000,0 MHz	50	70	—	dB
		2000,0 ... 3000,0 MHz	30	44	—	dB
		3000,0 ... 5000,0 MHz	18	29	—	dB
		5000,0 ... 6000,0 MHz	10	28	—	dB
<b>Symmetry in band</b> (referenced to the matched operating condition)						
	$ S_{31} / S_{21} $	880,0 ... 915,0 MHz	-1,0	0	1,0	dB
	$\arg(S_{31}/S_{21})$	880,0 ... 915,0 MHz	170	180	190	°



SAW Components

B4140

Low-Loss Filter for Mobile Communication

897,50 MHz

Data Sheet



**Characteristics**

Operating temperature range:  $T = -10$  to  $+80$  °C  
 Terminating source impedance:  $Z_S = 50 \Omega$   
 Terminating load impedance:  $Z_L = 200 \Omega \parallel 56 \text{ nH}$   
 ( L simulated with Q factor 20 )

				min.	typ.	max.	
<b>Center frequency</b>		$f_C$		—	897,5	—	MHz
<b>Maximum insertion attenuation</b>	880,0 ... 915,0	MHz	$\alpha_{max}$	—	3,2	4,2	dB
<b>Amplitude ripple (p-p)</b>	880,0 ... 915,0	MHz	$\Delta\alpha$	—	1,6	2,3	dB
<b>Input VSWR</b>	880,0 ... 915,0	MHz		—	1,7	2,2	
<b>Output VSWR</b>	880,0 ... 915,0	MHz		—	1,6	2,2	
<b>Attenuation</b>			$\alpha$				
	0,0 ... 600,0	MHz		60	77	—	dB
	600,0 ... 800,0	MHz		50	72	—	dB
	800,0 ... 860,0	MHz		35	44	—	dB
	925,0 ... 935,0	MHz		7	11	—	dB
	935,0 ... 960,0	MHz		23	26	—	dB
	960,0 ... 1000,0	MHz		25	40	—	dB
	1000,0 ... 1050,0	MHz		40	64	—	dB
	1050,0 ... 1500,0	MHz		55	68	—	dB
	1500,0 ... 2000,0	MHz		50	70	—	dB
	2000,0 ... 3000,0	MHz		30	44	—	dB
	3000,0 ... 5000,0	MHz		18	29	—	dB
	5000,0 ... 6000,0	MHz		10	28	—	dB
<b>Symmetry in band</b> (referenced to the matched operating condition)							
	$ S_{31} / S_{21} $	880,0 ... 915,0	MHz	-1,0	0	1,0	dB
	$\arg(S_{31}/S_{21})$	880,0 ... 915,0	MHz	170	180	190	°



**SAW Components**

**B4140**

**Low-Loss Filter for Mobile Communication**

**897,50 MHz**

**Data Sheet**



**Characteristics**

Operating temperature range:  $T = -25$  to  $+70$  °C  
 Terminating source impedance:  $Z_S = 50 \Omega$   
 Terminating load impedance:  $Z_L = 200 \Omega \parallel 56$  nH  
 ( L simulated with Q factor 20 )

			<b>min.</b>	<b>typ.</b>	<b>max.</b>	
<b>Center frequency</b>	$f_C$		—	897,5	—	MHz
<b>Maximum insertion attenuation</b>	$\alpha_{max}$	880,0 ... 915,0 MHz	—	3,4	4,5	dB
<b>Amplitude ripple (p-p)</b>	$\Delta\alpha$	880,0 ... 915,0 MHz	—	1,8	2,9	dB
<b>Input VSWR</b>		880,0 ... 915,0 MHz	—	2,1	2,4	
<b>Output VSWR</b>		880,0 ... 915,0 MHz	—	2,4	2,5	
<b>Attenuation</b>	$\alpha$					
		0,0 ... 600,0 MHz	60	77	—	dB
		600,0 ... 800,0 MHz	50	72	—	dB
		800,0 ... 860,0 MHz	35	44	—	dB
		860,0 ... 870,0 MHz	10	36	—	dB
		925,0 ... 935,0 MHz	7	11	—	dB
		935,0 ... 960,0 MHz	23	26	—	dB
		960,0 ... 1000,0 MHz	25	40	—	dB
		1000,0 ... 1050,0 MHz	40	64	—	dB
		1050,0 ... 1500,0 MHz	55	68	—	dB
		1500,0 ... 2000,0 MHz	50	70	—	dB
		2000,0 ... 3000,0 MHz	30	44	—	dB
		3000,0 ... 5000,0 MHz	18	29	—	dB
		5000,0 ... 6000,0 MHz	10	28	—	dB
<b>Symmetry in band</b> (referenced to the matched operating condition)						
	$ S_{31} / S_{21} $	880,0 ... 915,0 MHz	-1,0	0	1,0	dB
	$\arg(S_{31}/S_{21})$	880,0 ... 915,0 MHz	170	180	190	°



SAW Components

B4140

Low-Loss Filter for Mobile Communication

897,50 MHz

Data Sheet



Transfer function ( spec at 25 °C )

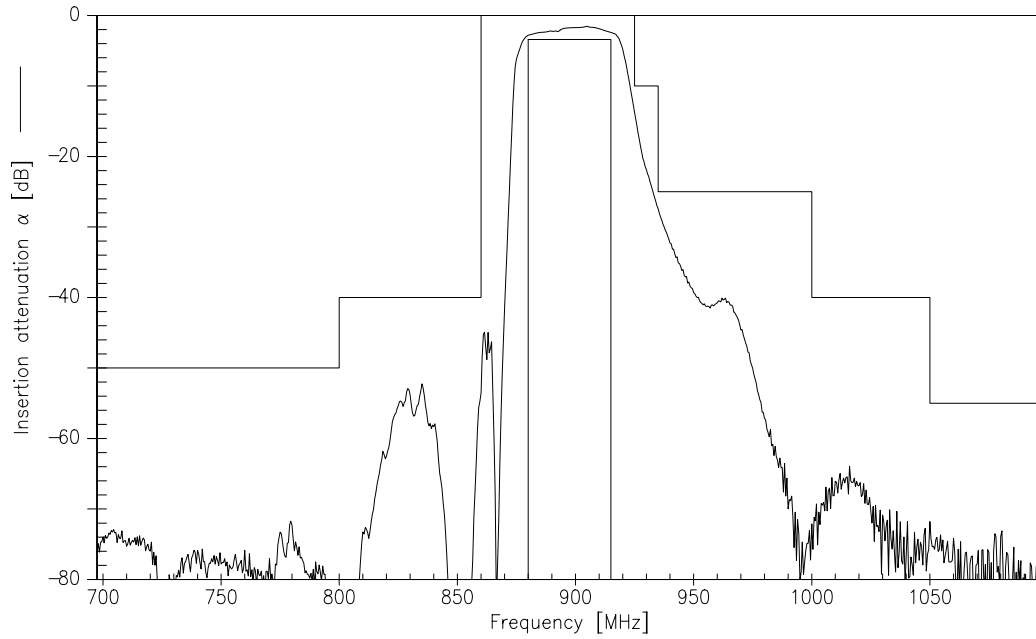

Transfer function ( wideband )

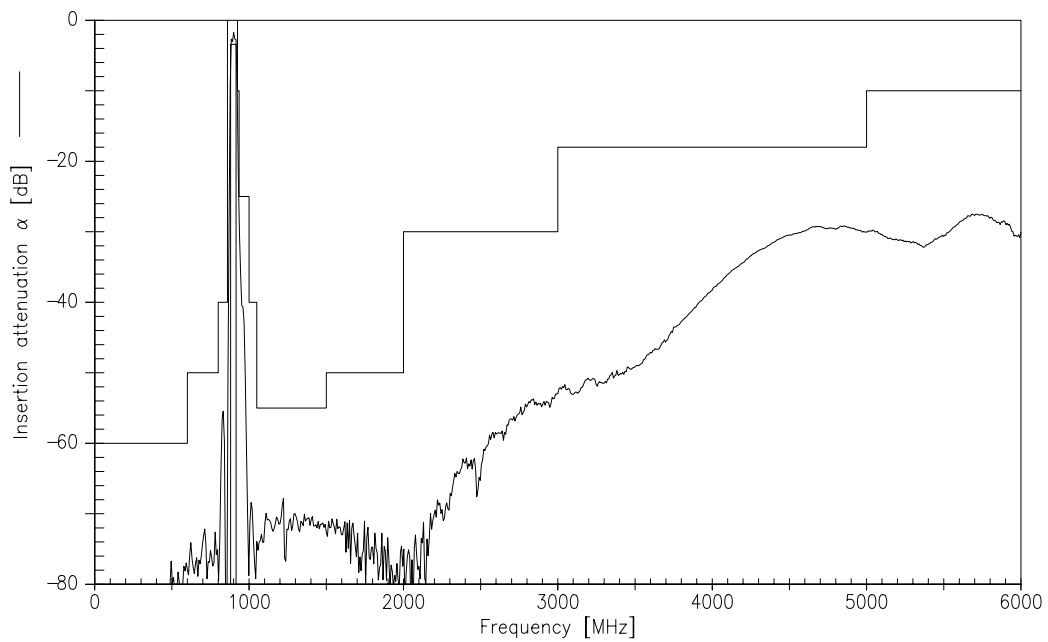





Input VSWR ( spec at 25 °C )

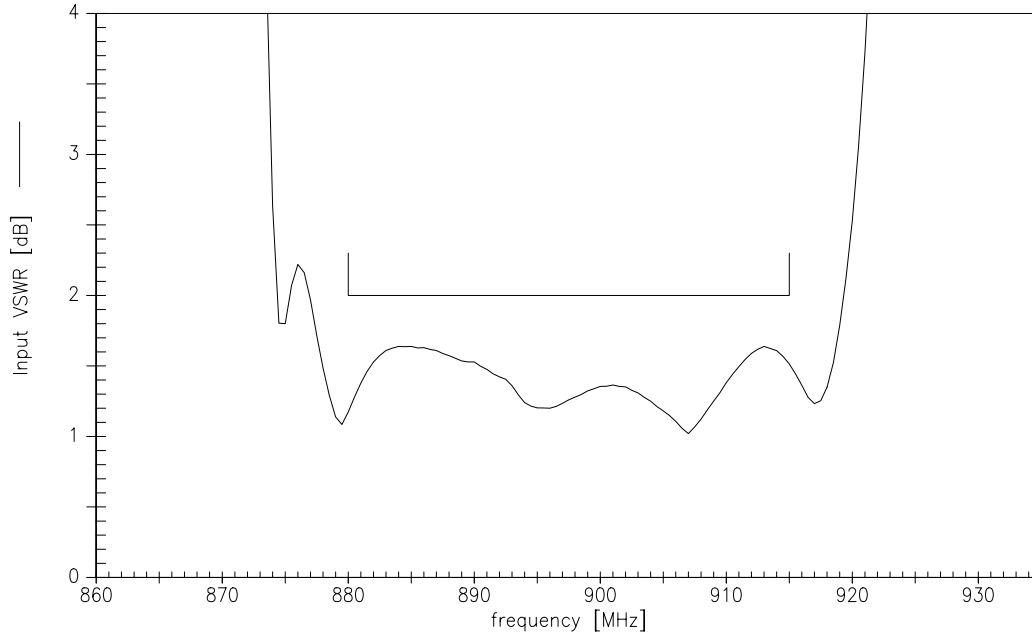

Output VSWR

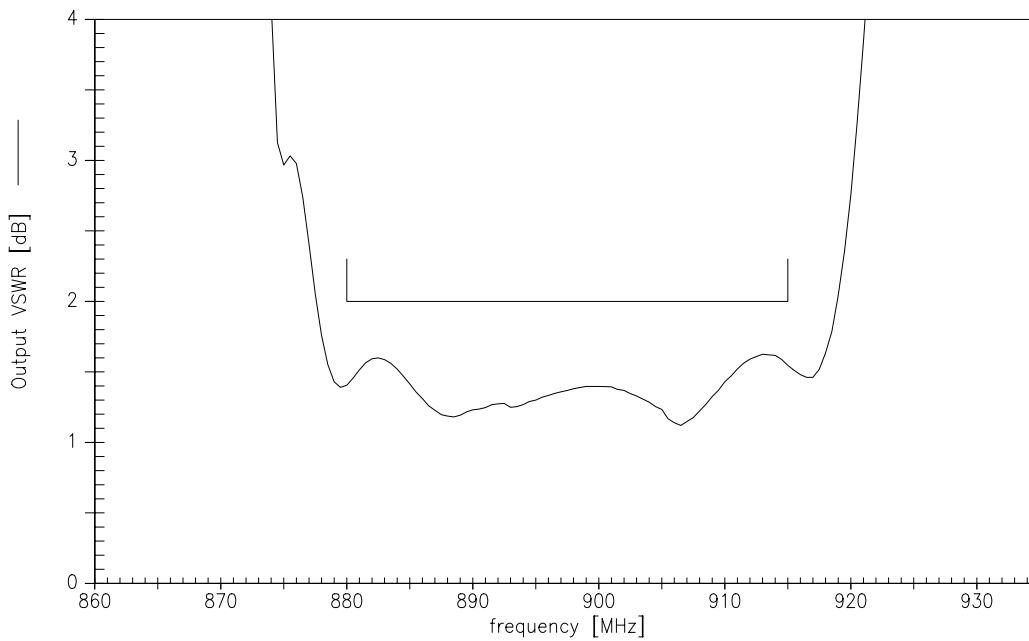



**Amplitude Symmetry  $|S_{31}|/|S_{21}|$**  (referenced to the matched operating condition)

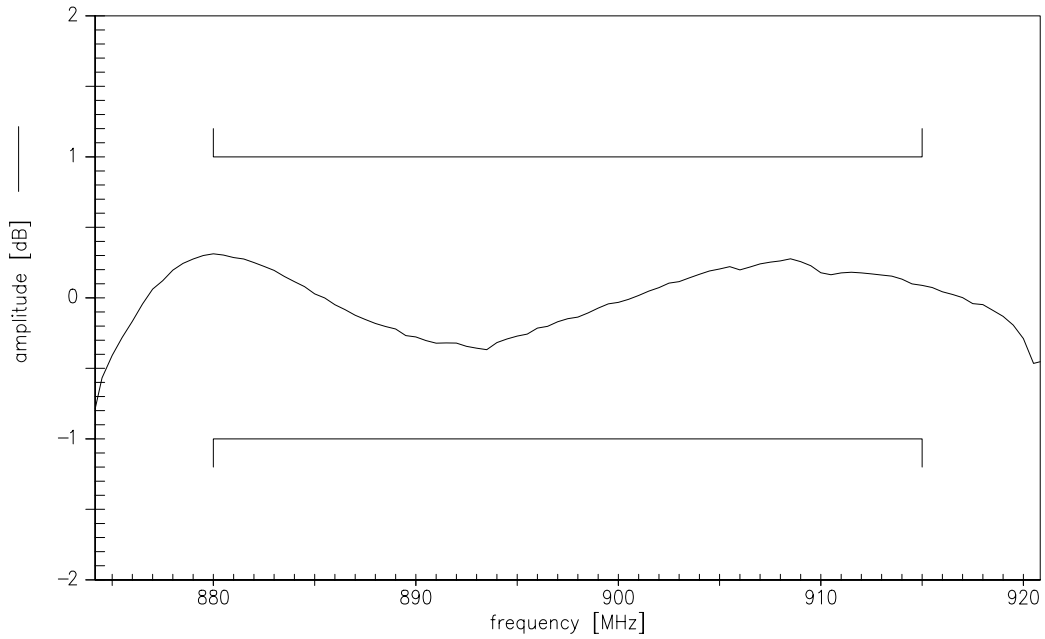

**Phase Symmetry  $\arg(S_{31}/S_{21}) - 180^\circ$**  (referenced to the matched operating condition)

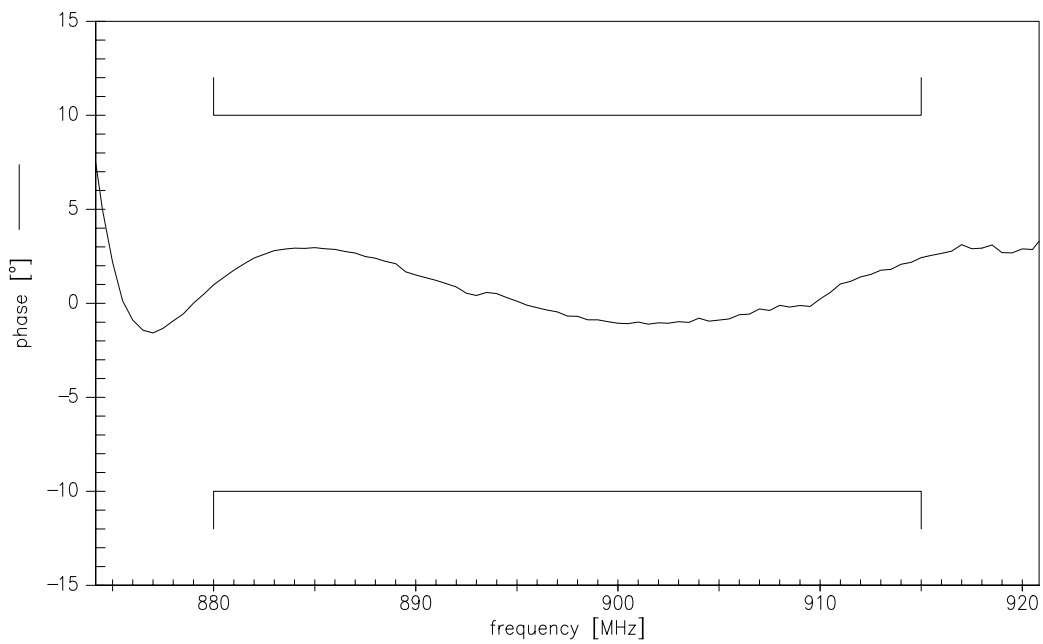



**SAW Components**

**B4140**

**Low-Loss Filter for Mobile Communication**

**897,50 MHz**

Data Sheet



**Published by EPCOS AG**

**Surface Acoustic Wave Components Division, OFW E MF**

**P.O. Box 80 17 09, D-81617 München**

© EPCOS AG 1999. All Rights Reserved.

As far as patents or other rights of third parties are concerned, liability is only assumed for components per se, not for applications, processes and circuits implemented within components or assemblies.

The information describes the type of component and shall not be considered as assured characteristics.

Terms of delivery and rights to change design reserved.

For questions on technology, prices and delivery please contact the sales offices of EPCOS AG or the international representatives.

Due to technical requirements components may contain dangerous substances. For information on the type in question please also contact one of our sales offices.