

**HDFKV 95**

for vertical conductor connection

Terminal width 25.0

(IEC)	rigid	flexible		I	U
[mm <sup>2</sup> ]	solid	stranded	AWG	[A]	[V]
Connection data	25-95	35-95	4-000	232	1)
1)Metal walls 1 (5) to 2.5 (6.5) mm					1000
Metal walls 2.5 (6.5) to 5 (9) mm					800
Metal walls 5 (9) to 6 (10) mm					690
Plastic walls 1 (5) to 6 (10) mm					1000

( ) Values in brackets apply to ...-DP version



Description	Type	Order No.	Pcs. Pkt.
<b>Panel feed-through terminal block</b> , with internal and external screw connection, external for vertical conductor	for 1 - 6 mm thick housing walls	<b>HDFKV 95</b>	<b>07 09 54 7</b> 10
	for 5 - 10 mm thick housing walls	<b>HDFKV 95-DP</b>	<b>07 09 66 0</b> 10
<b>Panel feed-through terminal block</b> , with internal and external screw connection, external for vertical conductor connection	for 1 - 6 mm thick housing walls	<b>HDFKV 95-F</b>	<b>07 09 67 3</b> 10
	for 5 - 10 mm thick housing walls	<b>HDFKV 95-DP-F</b>	<b>07 09 68 6</b> 10

external terminal half with screw flange,

**Accessories**

(1) <b>Insertion profile</b> , compensates prism-shaped sleeve base when using flat conductors		<b>UKH 95 EP</b>	<b>30 09 23 1</b> 10
(2) <b>Zack strip</b> , 10-section, white		<b>ZB 10</b> (see <a href="#">info</a> )	
(3) <b>Screwdriver</b>		<b>ISS 6</b>	<b>12 01 93 4</b> 1

**Technical data**

**Dimensions** see drawing

**Technical data in accordance with IEC/VDE**

Rated surge voltage / contamination class [kV] / – 8 / 3

Surge voltage category / insulation material group – / – III / I

**Connection capacity**

stranded with ferrule without / with plastic sleeve [mm<sup>2</sup>] 25 - 95 / 25 - 95

**Multi-conductor connection (2 conductors with same cross section)**

solid / stranded [mm<sup>2</sup>] 16 - 35 / 16 - 35

stranded with ferrule without plastic sleeve [mm<sup>2</sup>] 16 - 35

**Stripping length** [mm] 27

**Internal cylindrical gage (IEC 947-1:1988)** B 12

**Terminal sleeve: thread / torque** – / [Nm] M 8 / 15 - 20

**Insulation material** PA

Inflammability class acc. to UL 94 V0

Temperature indices RTI / Ti 130 / 120

**Approval data (UL and CSA)**

Nom. voltage / nom. current / conduc. sizes UL: [V] / [A] / AWG 600 / 230 / 4 - 4/0

CSA: [V] / [A] / AWG 600 / 200 / 2 - 4/0

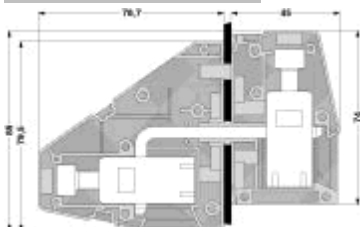
**Dimensional drawing**

HDFKV 95

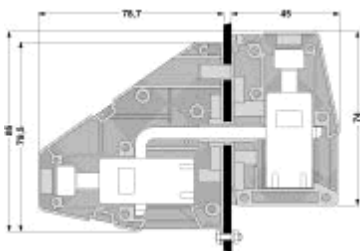
**Drilling diagram**

HDFKV 95-F

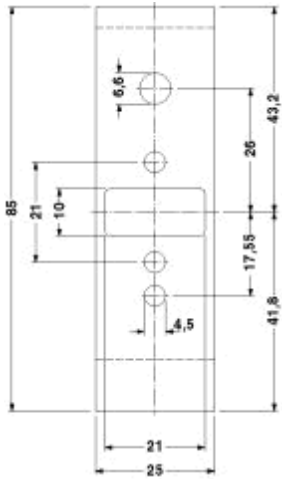

HDFKV 95-F

